

Corner Bridge Shelf

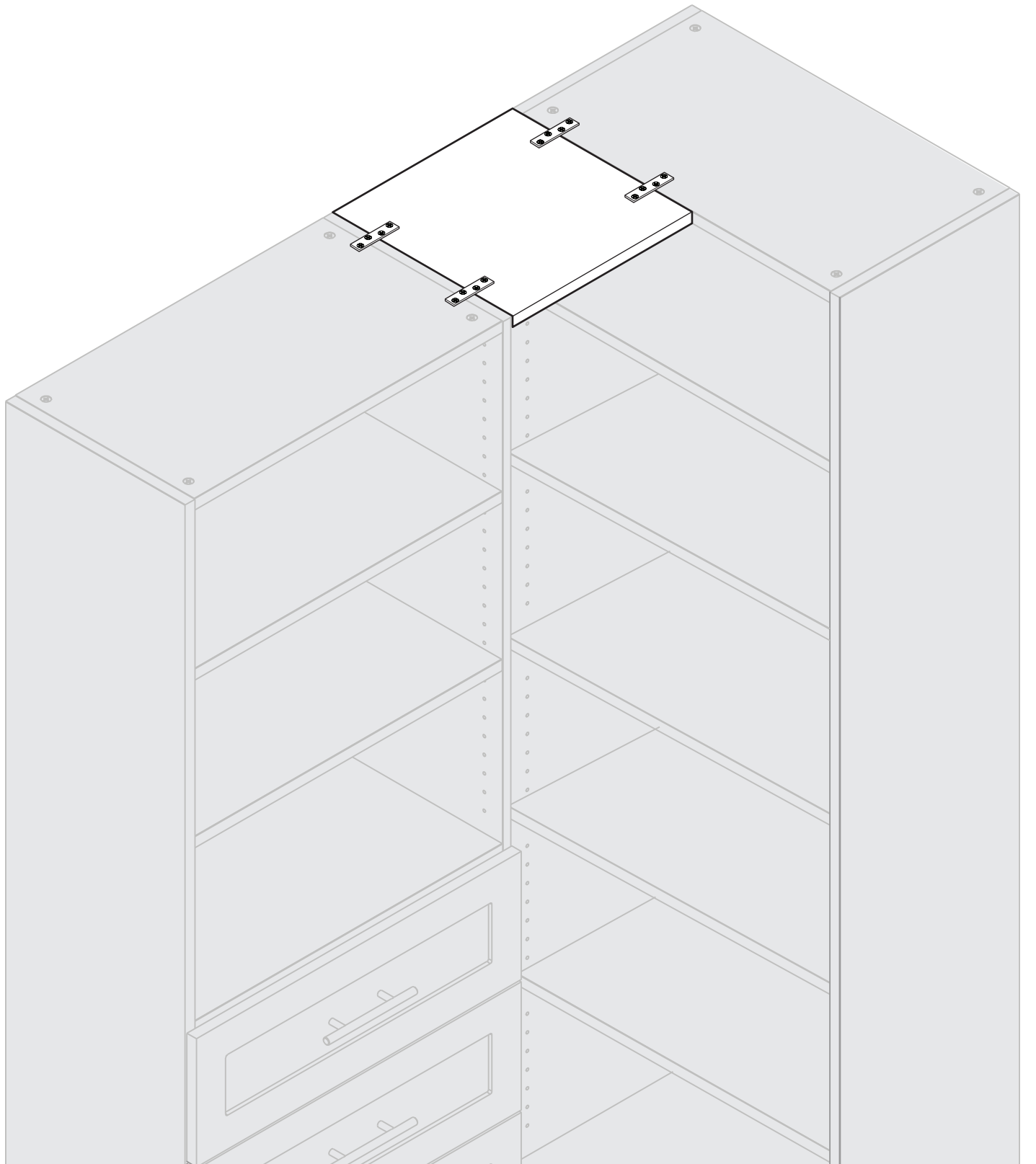

Corner Bridge Shelf

PARTS LIST

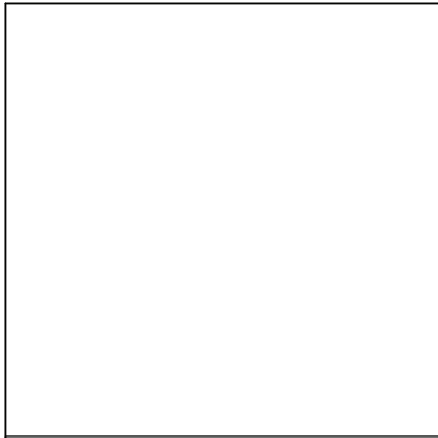

FINISHED EDGE

HARDWARE

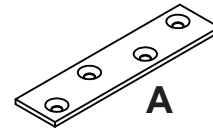

- A** Mending Plate (8)
- B** Small Wood Screw (32)

TOOLS REQUIRED

(not included)

Drill, 3/32" bit, #2 Phillips Driver,
Tape Measure, Circular or Miter Saw
(only if shelf requires trimming)

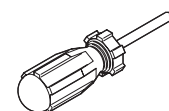
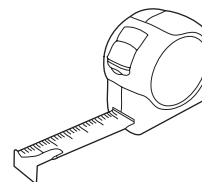
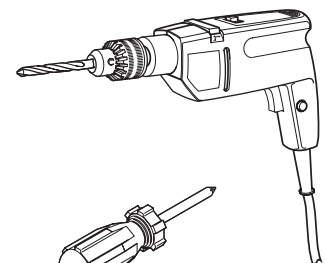
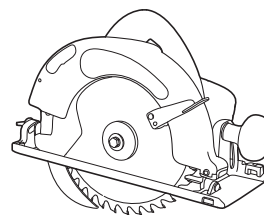

1

1.1 Lay out mending plates 3" from front and back edges of shelf

1.2 Mark hole centers and drill pilot hole with 3/32" drill bit

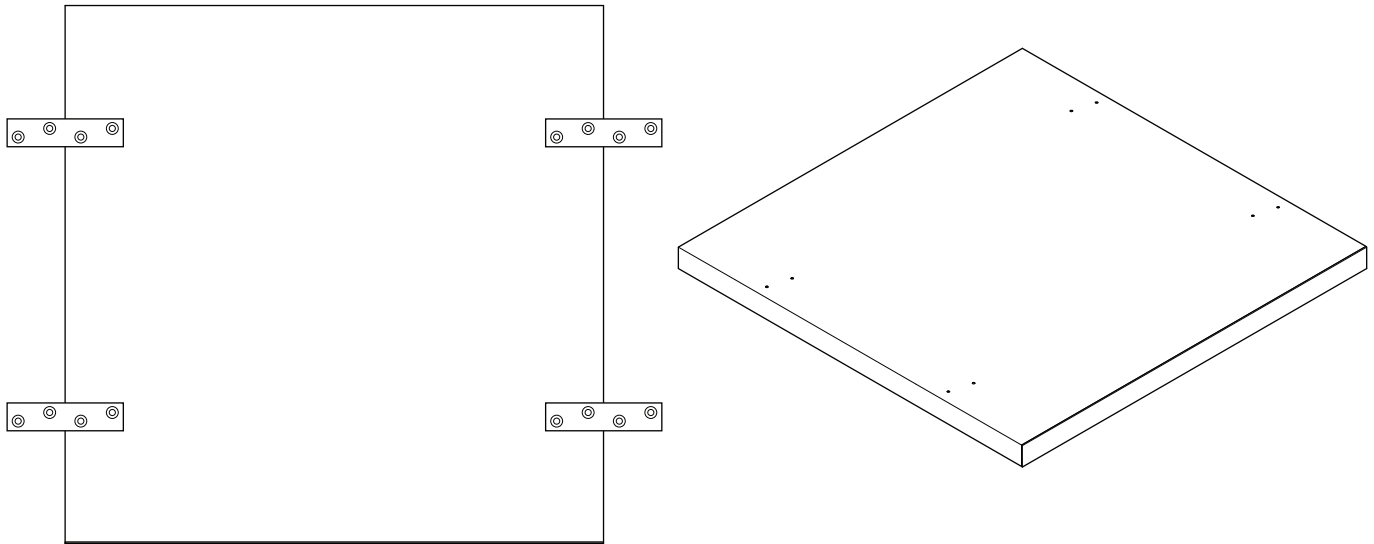

2

2.1 Use a #2 Phillips driver to install screws and attach mending plates

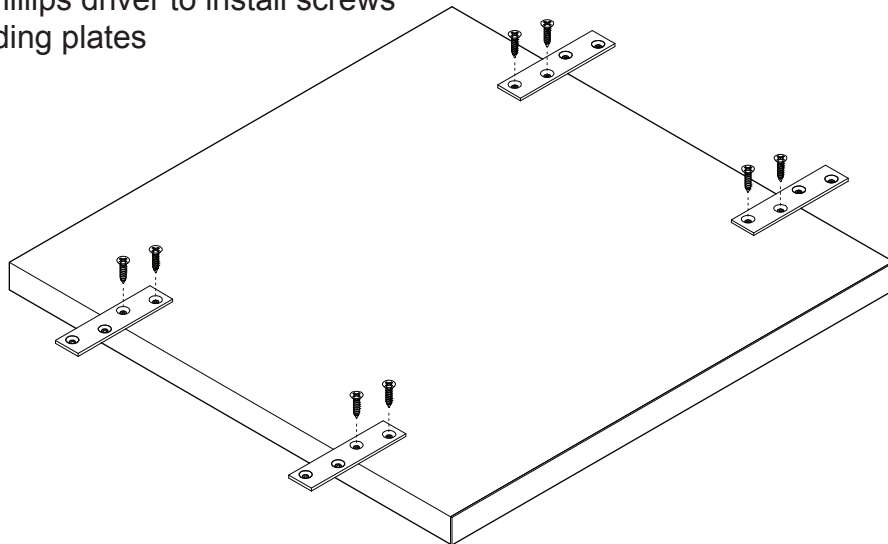

3

3.1 Measure the distance between modules in the corner of your room. (If there is less than 14" you will need to cut the bridge shelf to fit)

3.2 Mark hole centers on modules and drill pilot hole with 3/32" drill bit

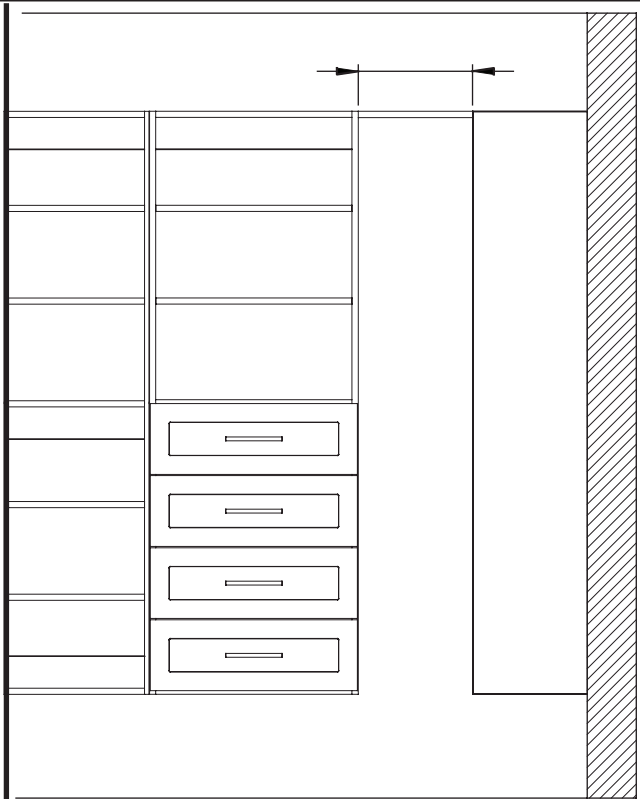

3.3 Complete the assembly by installing screws through the mending plates into the modules

