

ALTO Wardrobe

ASSEMBLY INSTRUCTIONS

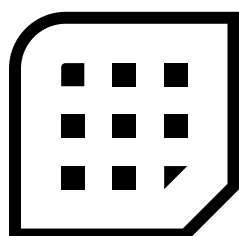

**modular
closets.**

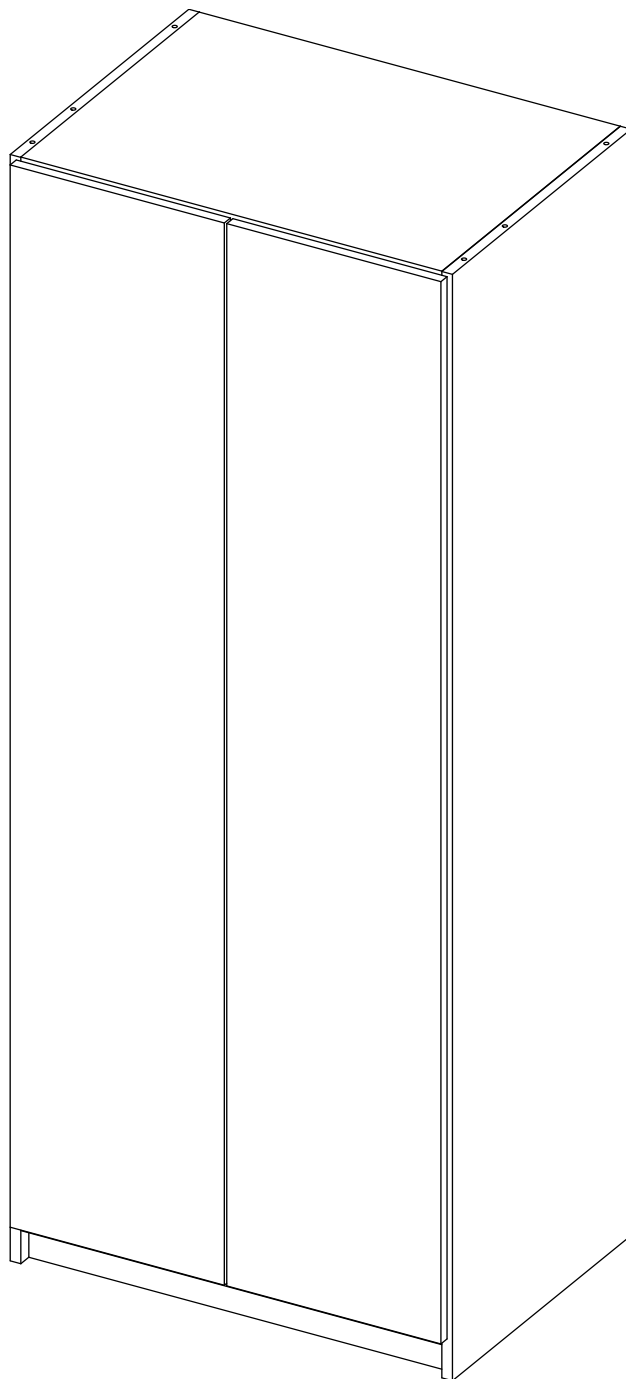

Congratulations on your purchase!

For any questions reach out to support@modularclosets.com or call
844-969-4247

Thank you for choosing Modular Closets and our Alto closet system!

We are committed to providing you with a seamless and efficient storage solution that enhances the organization and functionality of your space. Before you embark on assembling your new Alto closet system, we want to emphasize a crucial step to ensure a smooth and successful installation.

Important: Understanding Your Components

Before you begin the assembly process, it is essential to familiarize yourself with the components provided in your package. Our Alto closet system includes various boxes containing different parts designated for specific towers. Properly identifying and organizing these components will prevent confusion and streamline the installation.

What You Need to Do

- 1. Inventory Check:** Begin by unpacking all the boxes and verifying the contents against the parts list provided. Ensure that you have all the necessary components and hardware.
- 2. Label and Sort:** Carefully read the labels on each box and sort the components according to the designated towers. This step is critical as it will help you avoid mixing parts that belong to different sections of the closet system.
- 3. Check Sizes:** Verify the sizes of the components against the measurements specified in your design PDF. Ensuring that each part matches the intended dimensions is crucial for a proper fit and installation.
- 4. Reference Your Design PDF:** Use the design PDF provided with your order to map out the correct placement of each component. This document will guide you in matching the parts to their specific locations within the closet system.
- 5. Read the Instructions:** Thoroughly read through the entire instruction manual before starting the assembly. Understanding the overall process and the sequence of steps will save you time and effort.

By taking the time to carefully organize, understand your components, and reference your design PDF, you set the stage for a successful and stress-free installation. We are confident that with a little preparation, you will find the assembly process straightforward and rewarding. Thank you for your attention to these important details.

Now, let's get started on transforming your space with your new Alto closet system from Modular Closets!



The base units will be built and installed first in the following steps, and on page 45 starts the interior components assembly

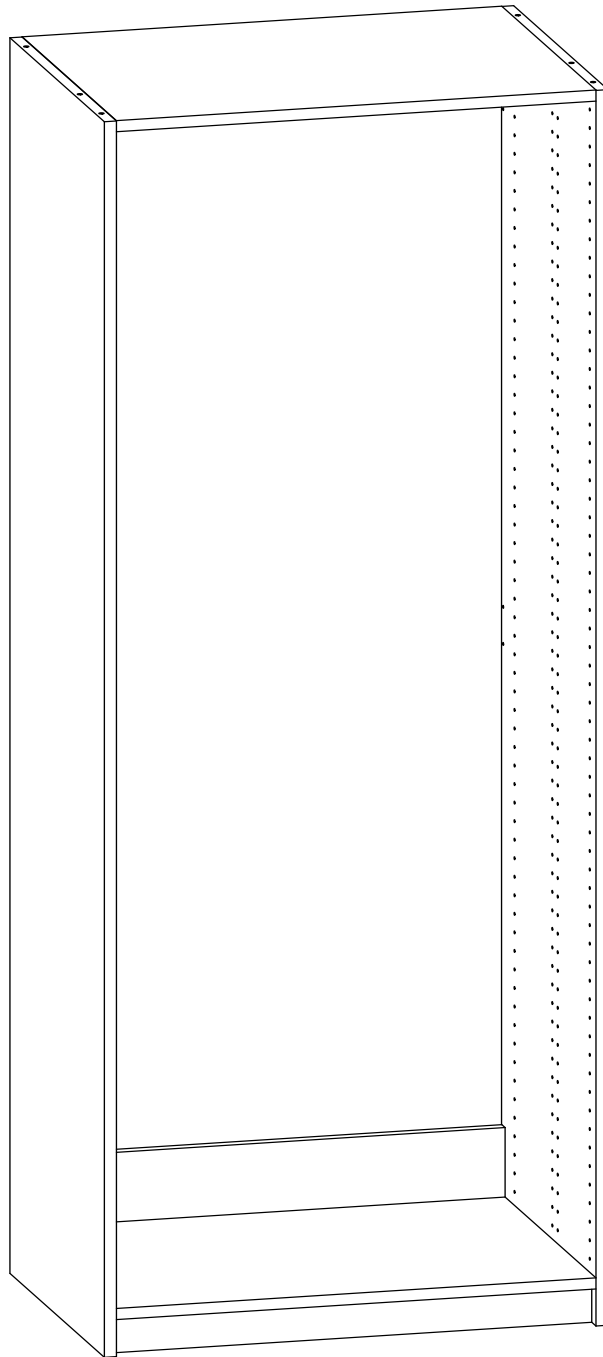



Boxes Needed

ALT-SP Alto Side Panel Pack

*There are no Right and Left as
each panel is built to be able to
go on either side.*

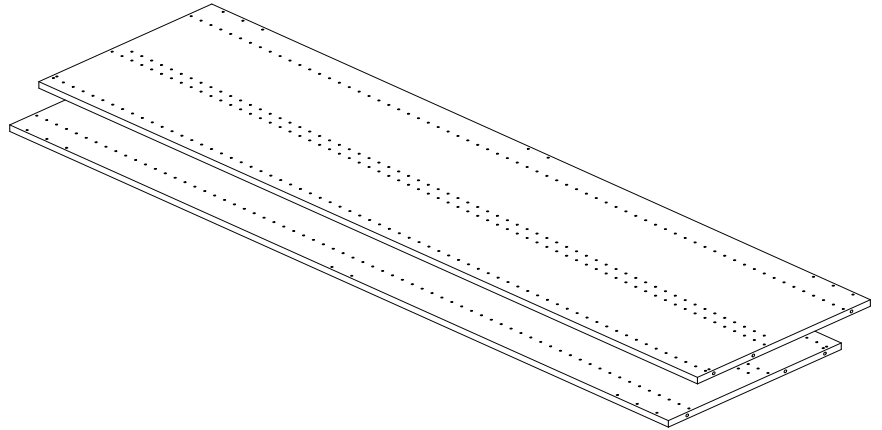

ALT-WDR-FS Alto Fixed Shelf Pack

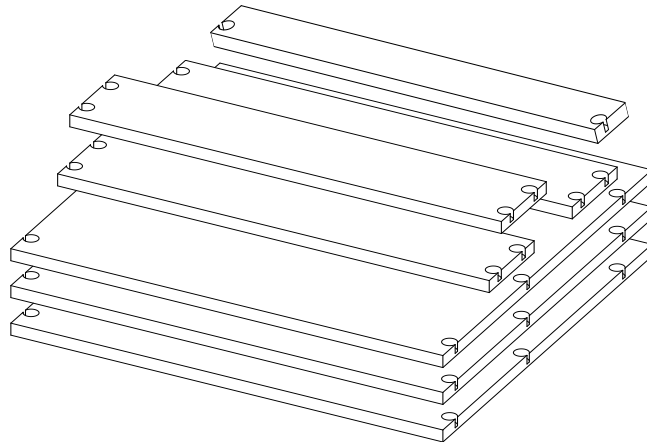

For combined units



ALT-CP Alto Center Panel (1 or 2 Pack)

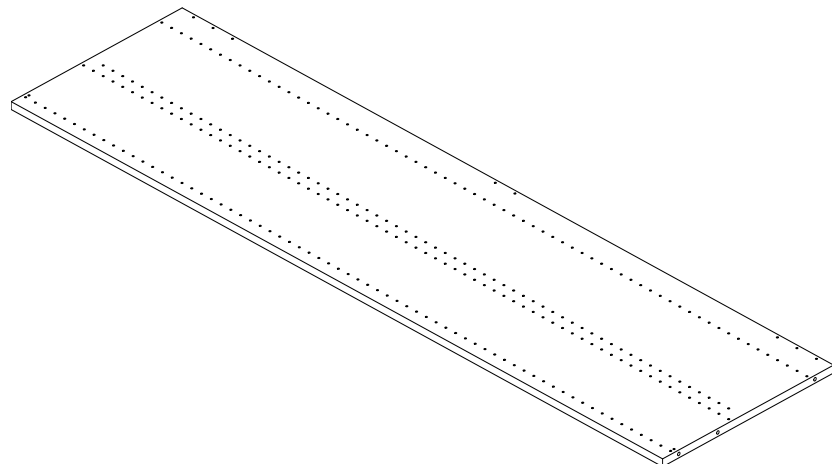



Hardware Packs Needed
ALT-HRDP-XXX

rafix
x16

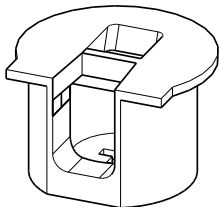

with locking mechanism

wedgefix
x16

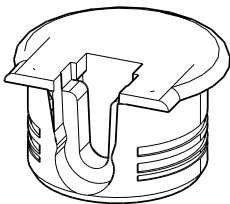

screw dowel
x32

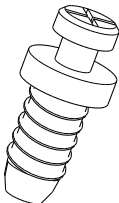

shelf pin
x2

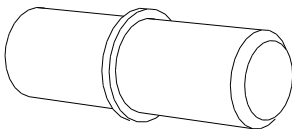

anchor screws
x4

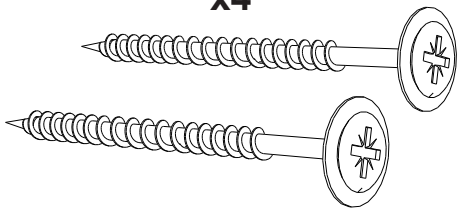

leveling wedge

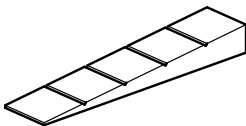

Tools needed

Rubber mallet

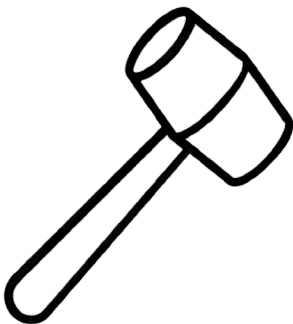

Drill

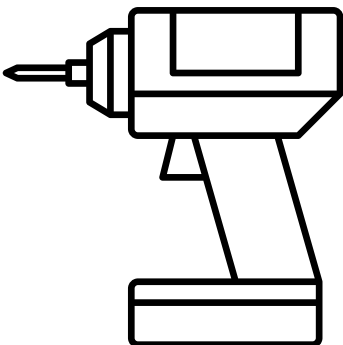

Level

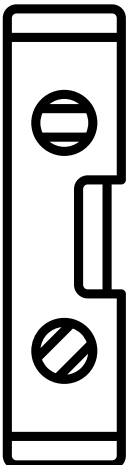

Philips
screw
driver



Stud finder

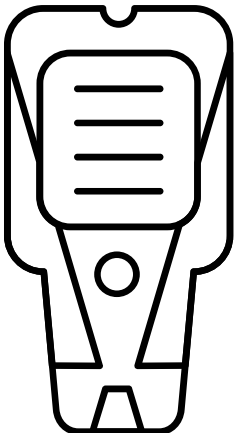

2 person assembly suggested



Step 1

From Box ALT-WDR-FS take 2 shelves and the toe kick and insert the rafixes as shown below.

rafix
x14

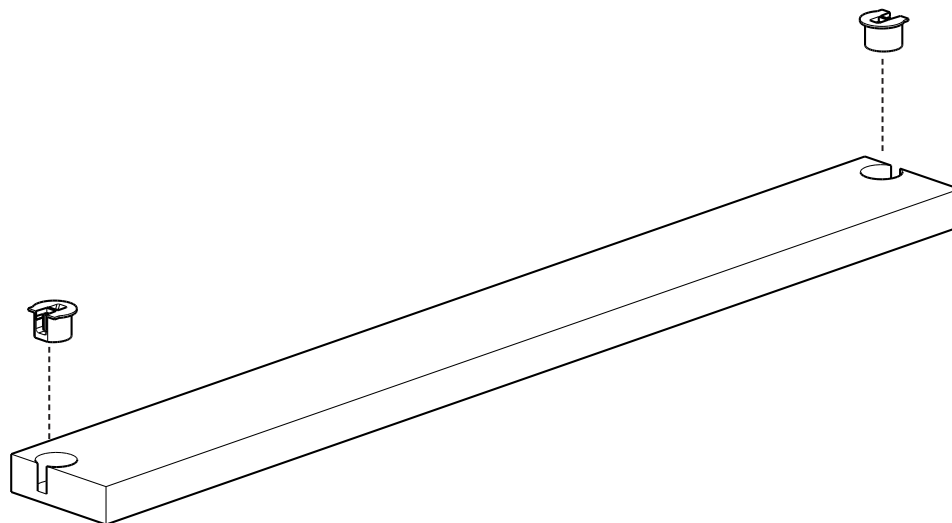
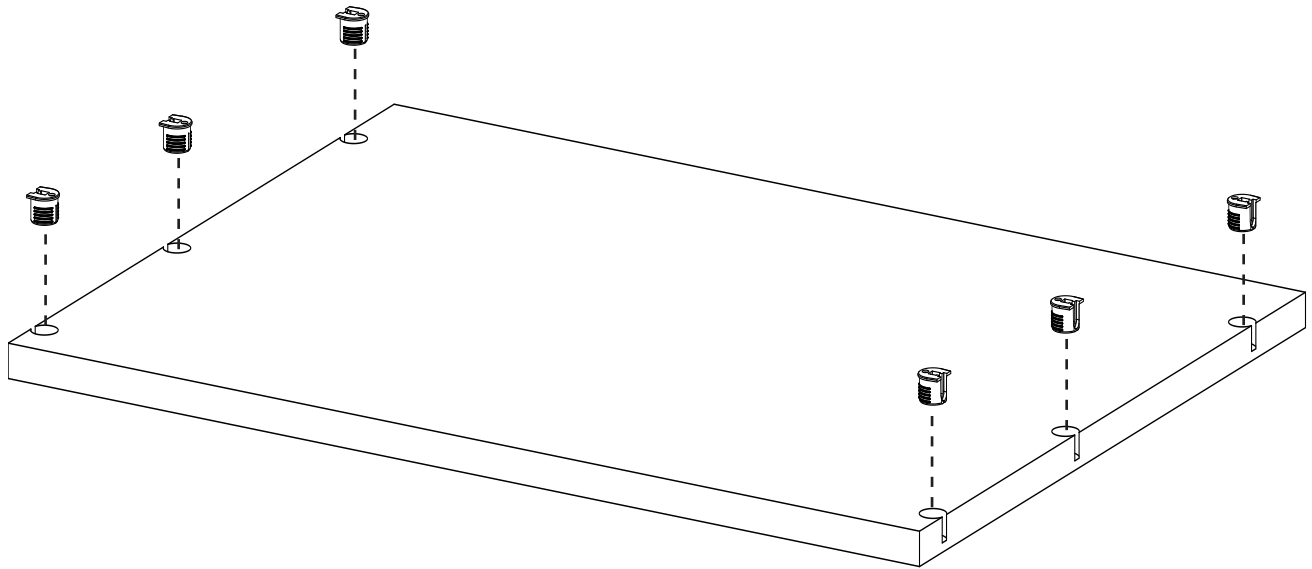



Step 2

For the 3rd fixed shelf, insert 2 rafixes in the holes closer to the unfinished edge, and 2 wedgefixes in the holes closer to the finished edge.

rafix
x2



wedgefix
x4

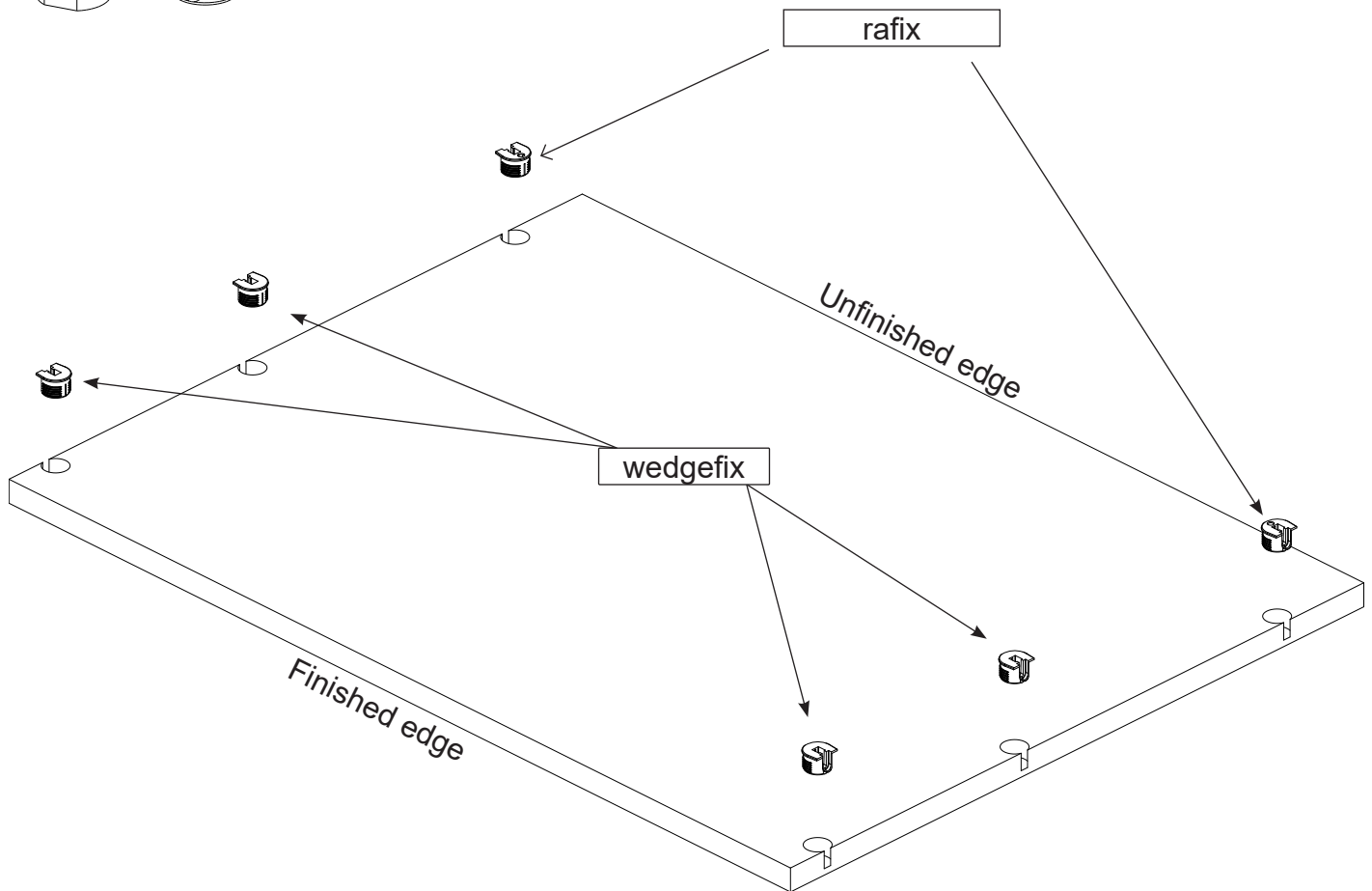

This will be used as the bottom fixed shelf



Step 3

Insert wedgefixes into 2 (or for tall hanging, 3) cleats.

wedgefix
x12

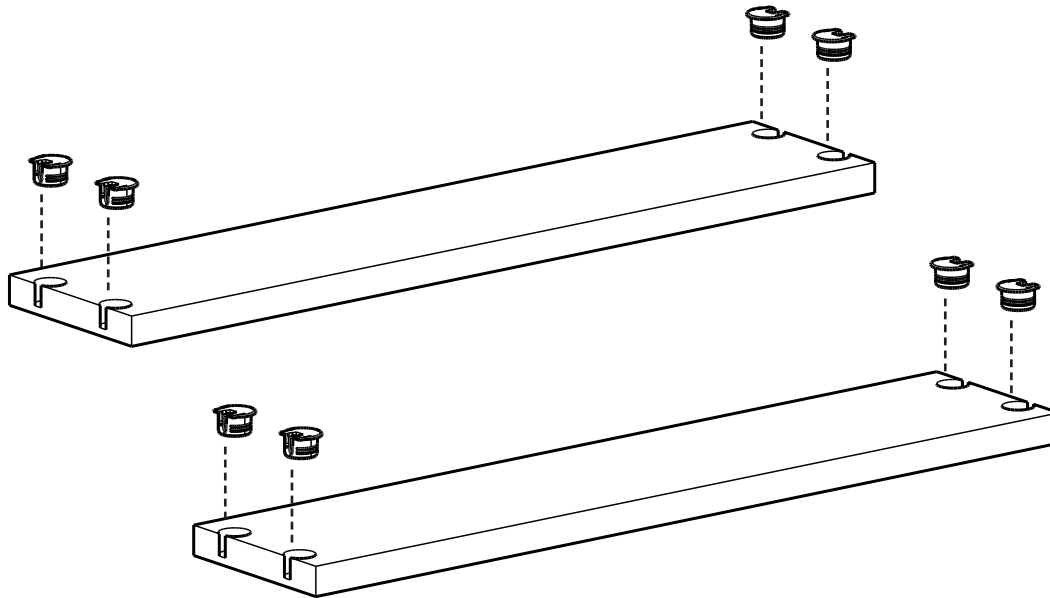

The third cleat will only be used in a tall hanging configuration

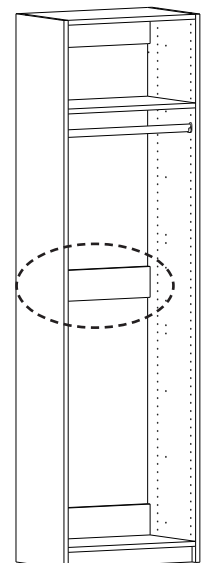
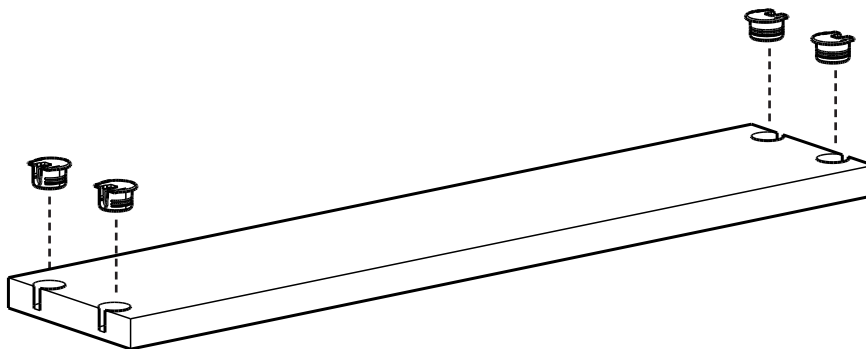

Repeat the above 3 steps for all the fixed shelf packs



Step 4

Next, open the side panel pack ALT-SP and insert the screws on the first panel as shown below.

Shelf pin

x1



Screw dowel

x11

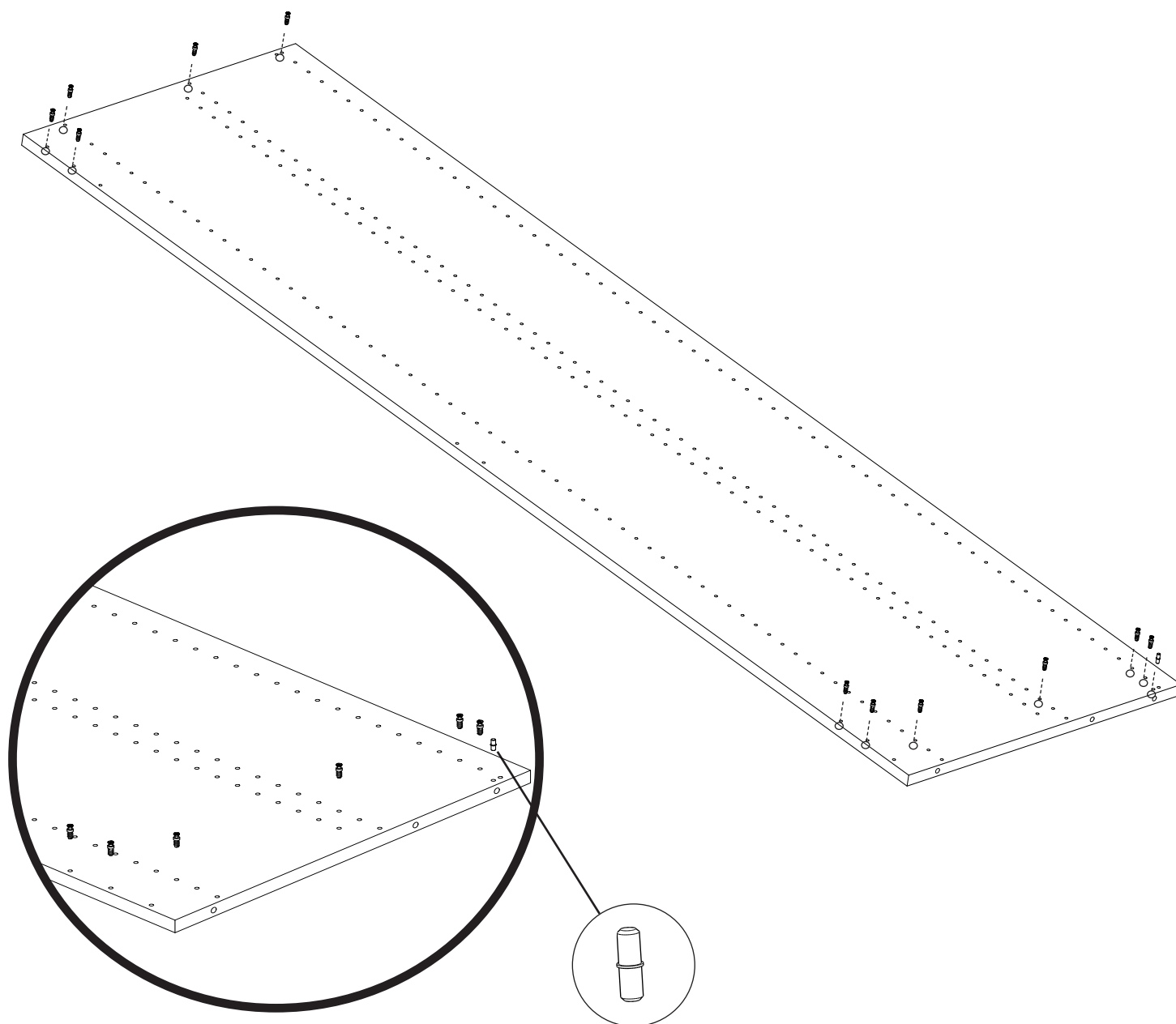



Step 5

Insert the screws into the second panel as shown below.

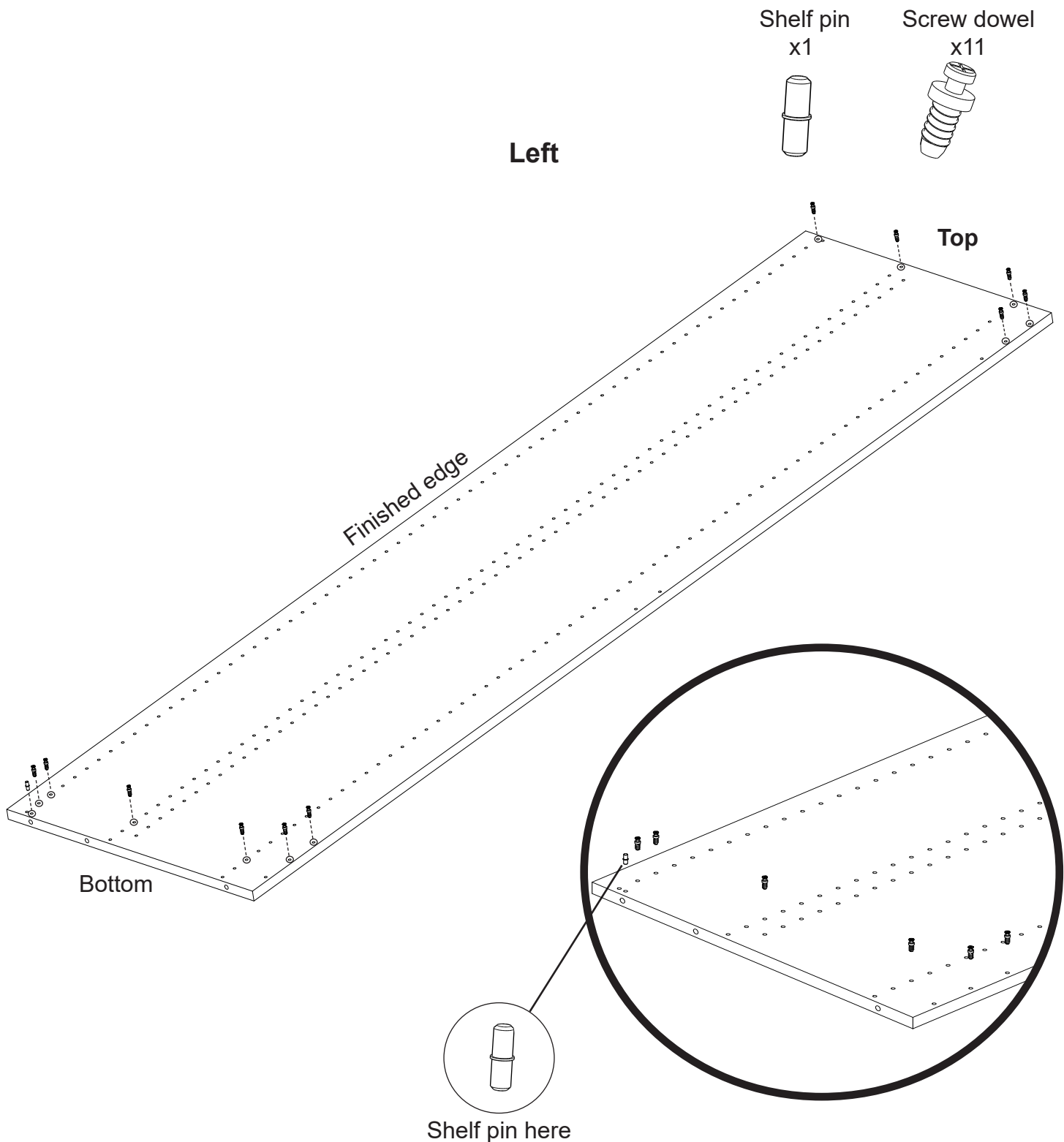

**Step 6**

If using Center Panels:

From box ALT-CP take the side panel and insert screw dowel as shown in step 4. Then flip it over, and insert dowels as shown in step 5.

Shelf pin
x2



Screw dowel
x22

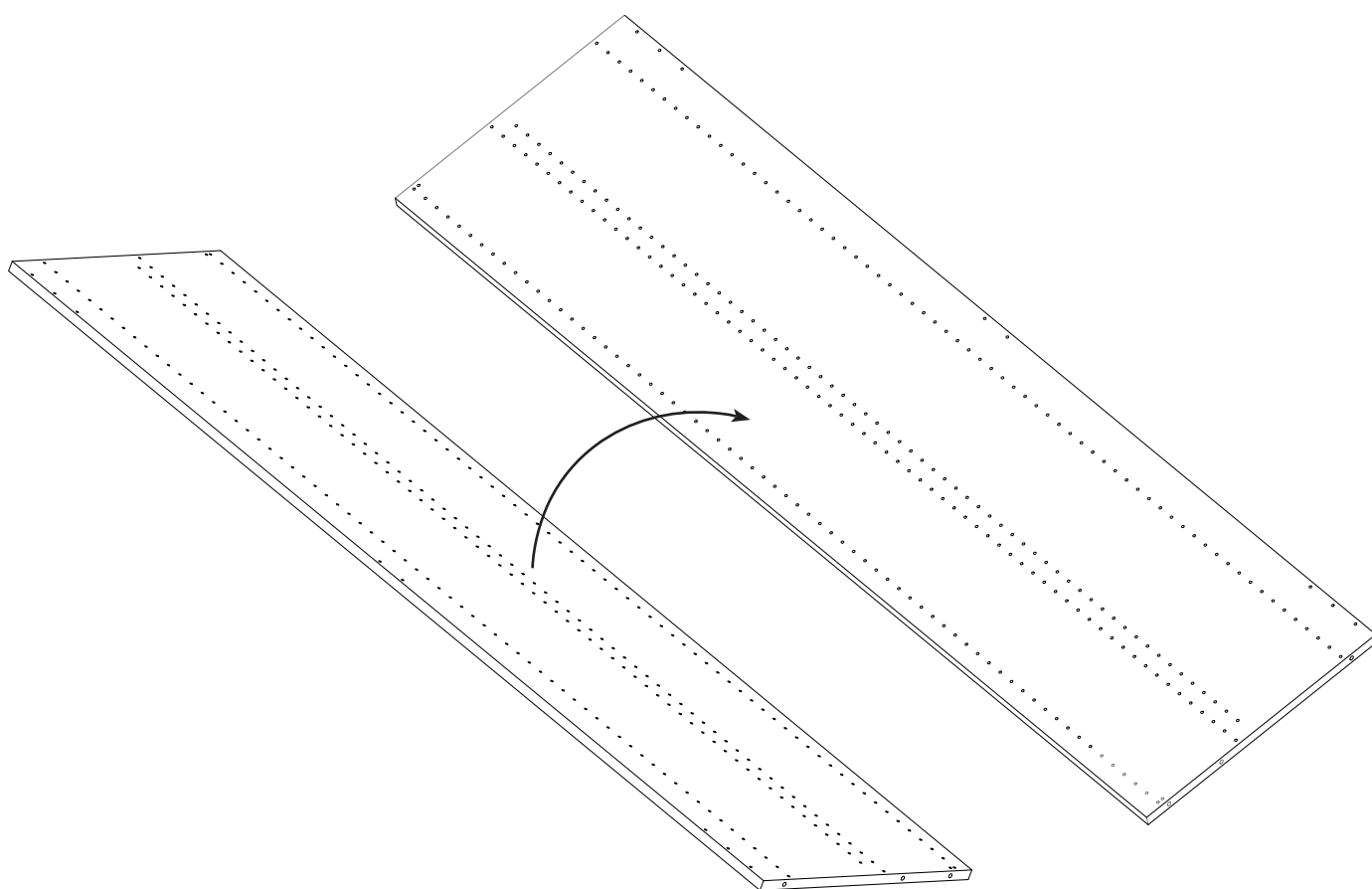



Step 7

Line up the panels along the wall in the order that the panels will be installed. Side panels will be on each end with center panels in the middle. Set up piles with the fixed shelves and cleats in between the panels, in order to have them on hand during the installation. Ensure that you have the correct sizes in the correct spots.

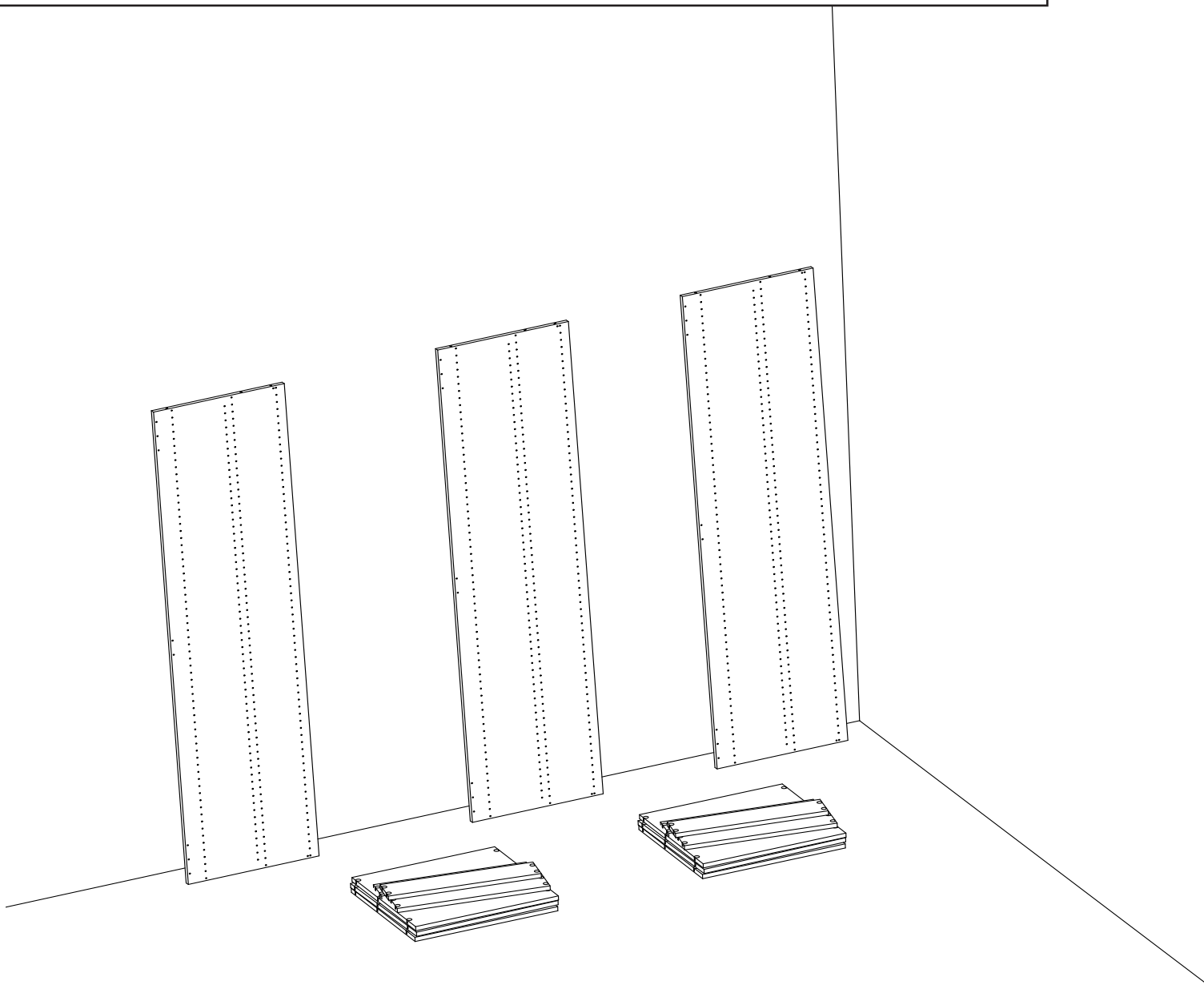

Step 7b

Remove the moldings from your space so the closet should be flush against the wall, this can be done with a hammer and flat head screw driver as shown.

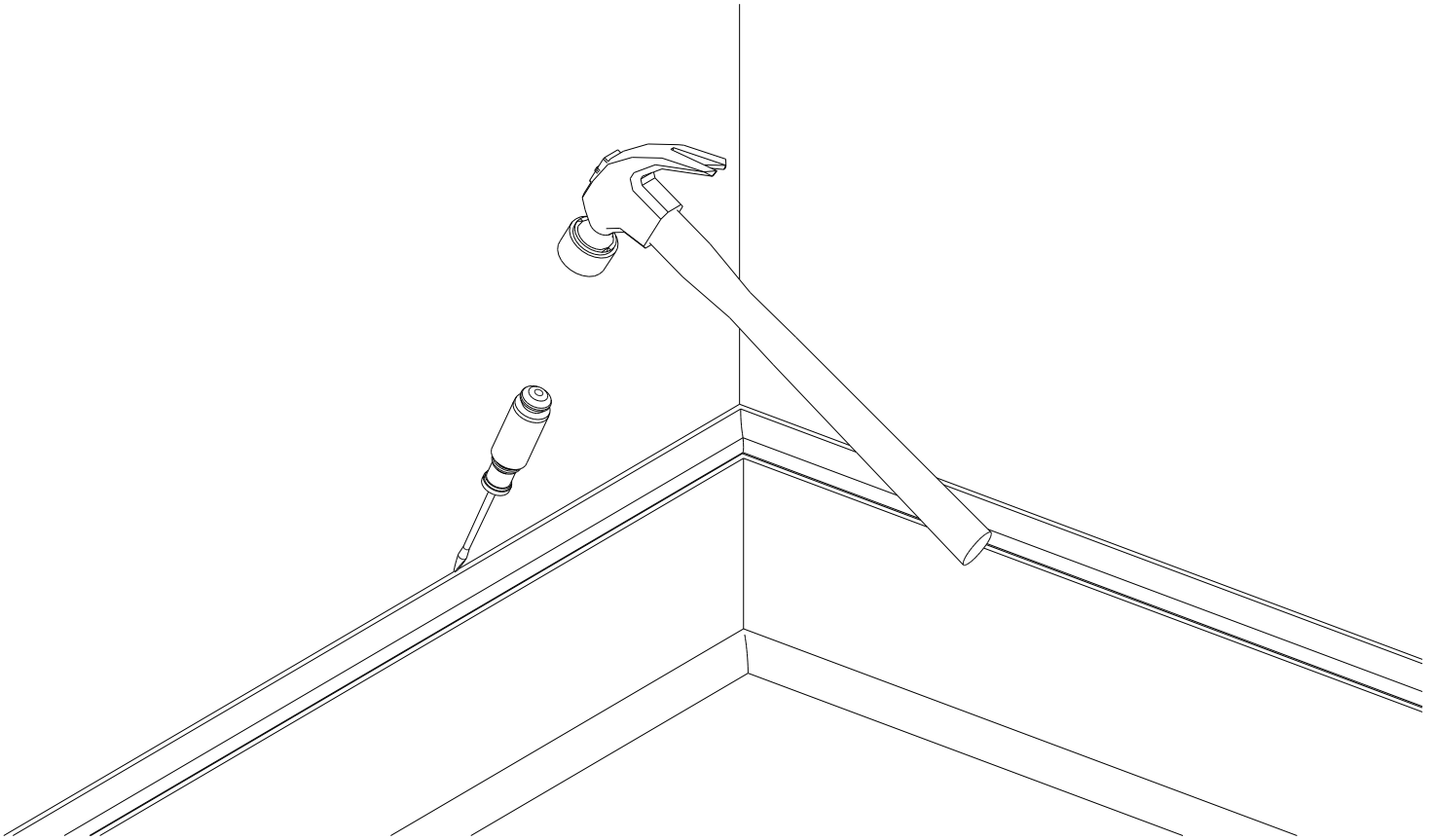



Step 8

Connect the left-most side panel to the adjacent center panel by attaching 1 of the fixed shelves (rafixes only) onto the top of the panels, as shown below. (refer to your closet plan to ensure the correct shelf size)

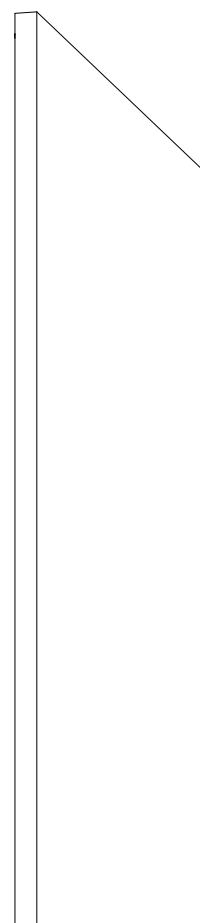
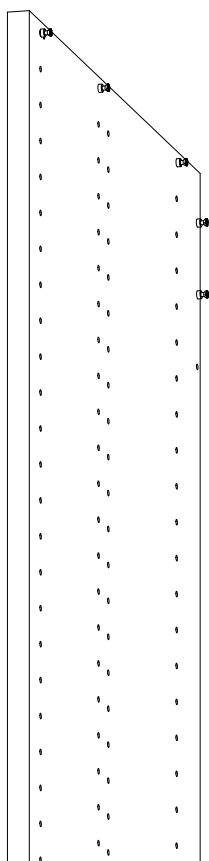
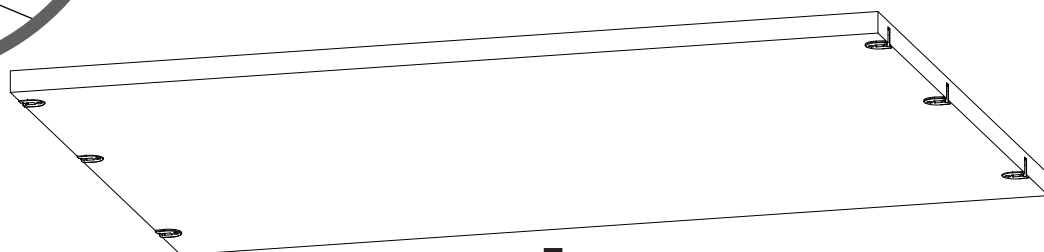
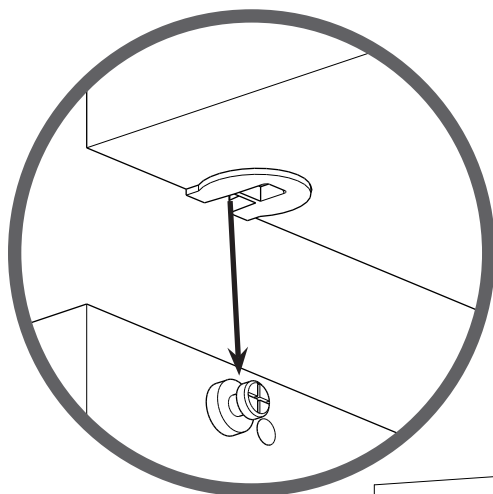

Step 9

Hold steady and connect the cleat to the panels by simply clicking the wedgfixes into the screw dowels on each side.

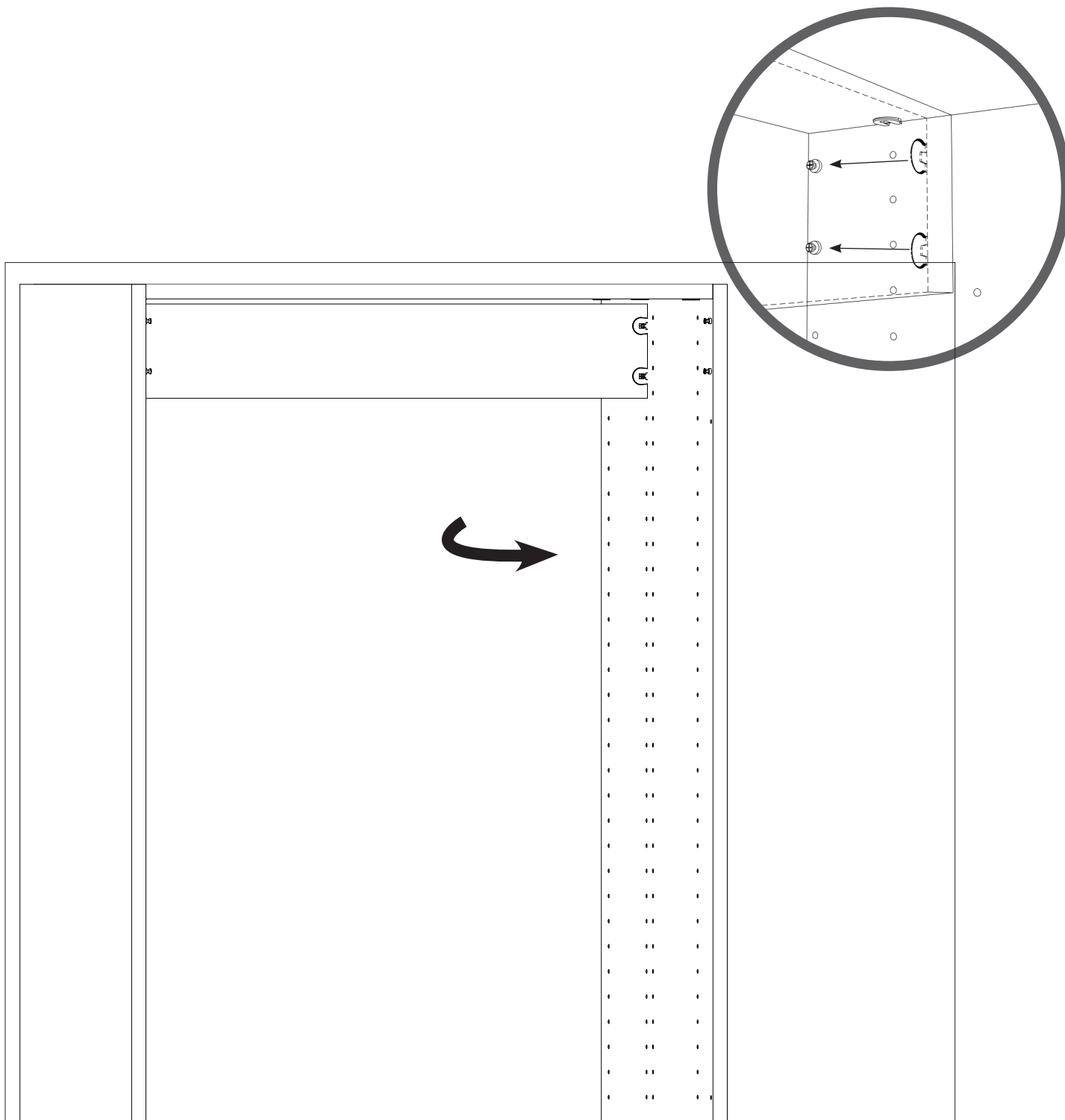



Step 10

Using a Philips screw driver, tighten and secure all 6 rafixes

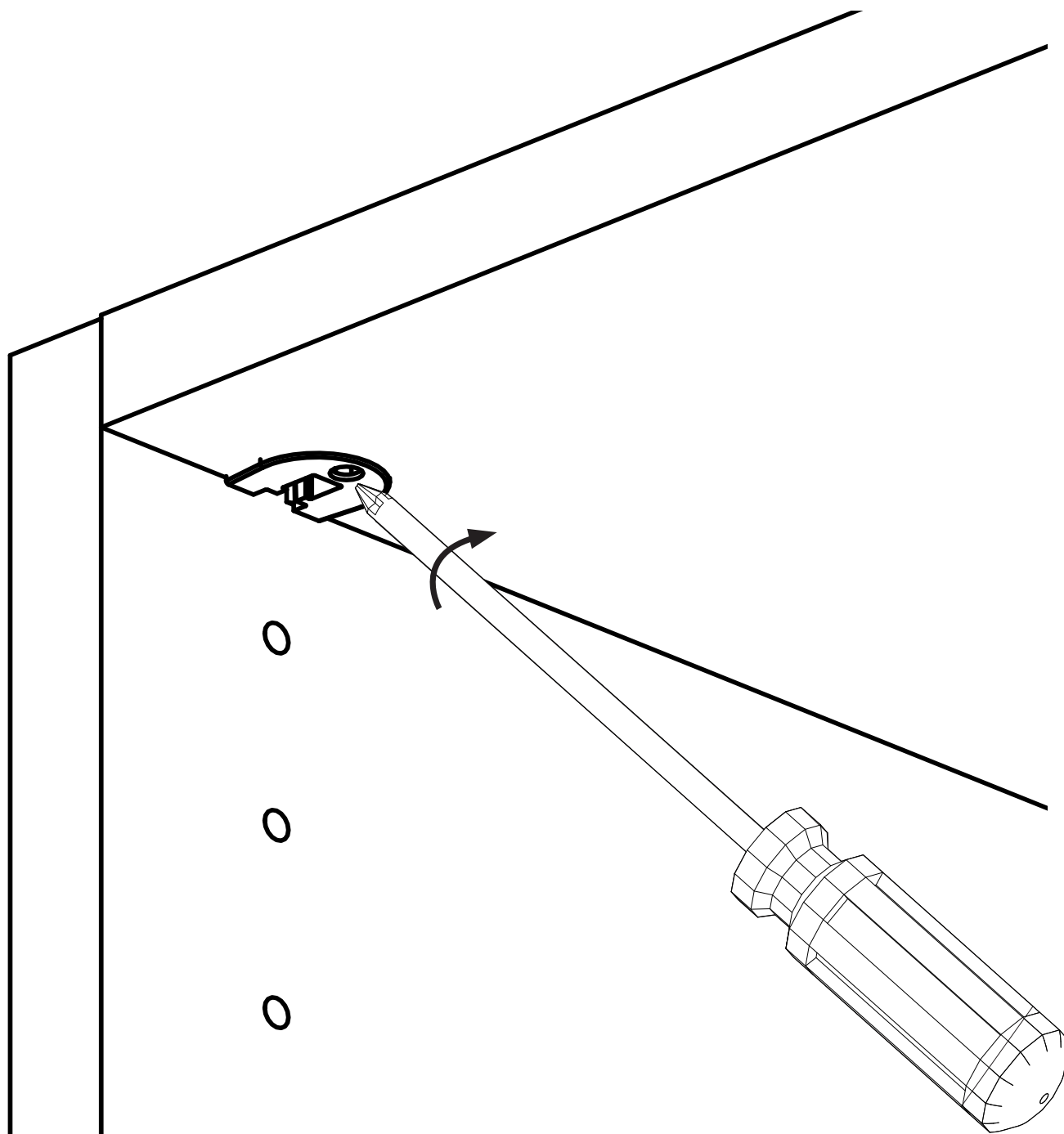

Step 11

Insert the bottom fixed shelf (with 2 rafixes and 4 wedgefixes from step 2) and insert the back 2 rafixes into the screw dowels as shown below.

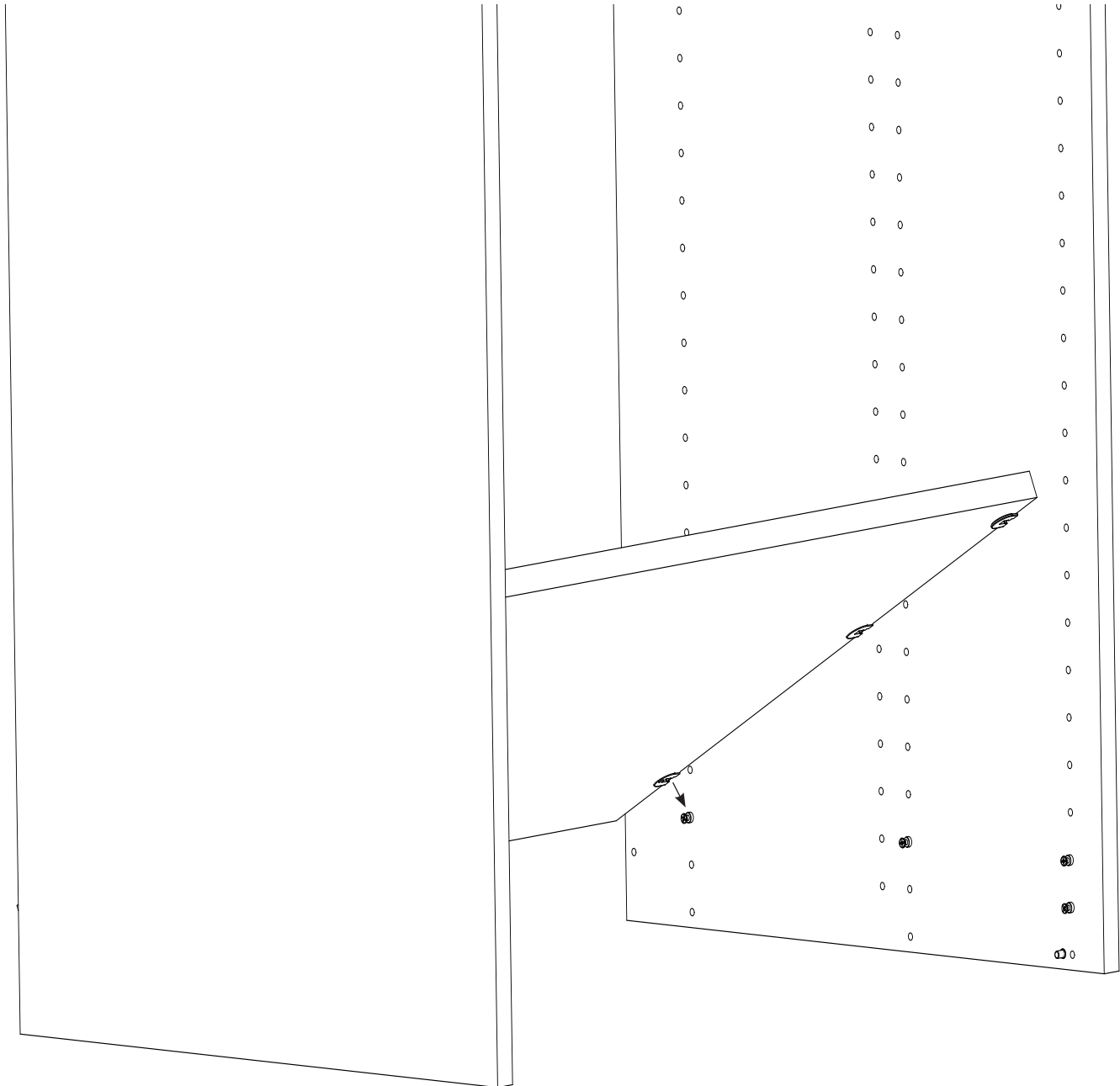



Step 12

Hold the shelf at an angle and tighten and secure the rafixes on either side

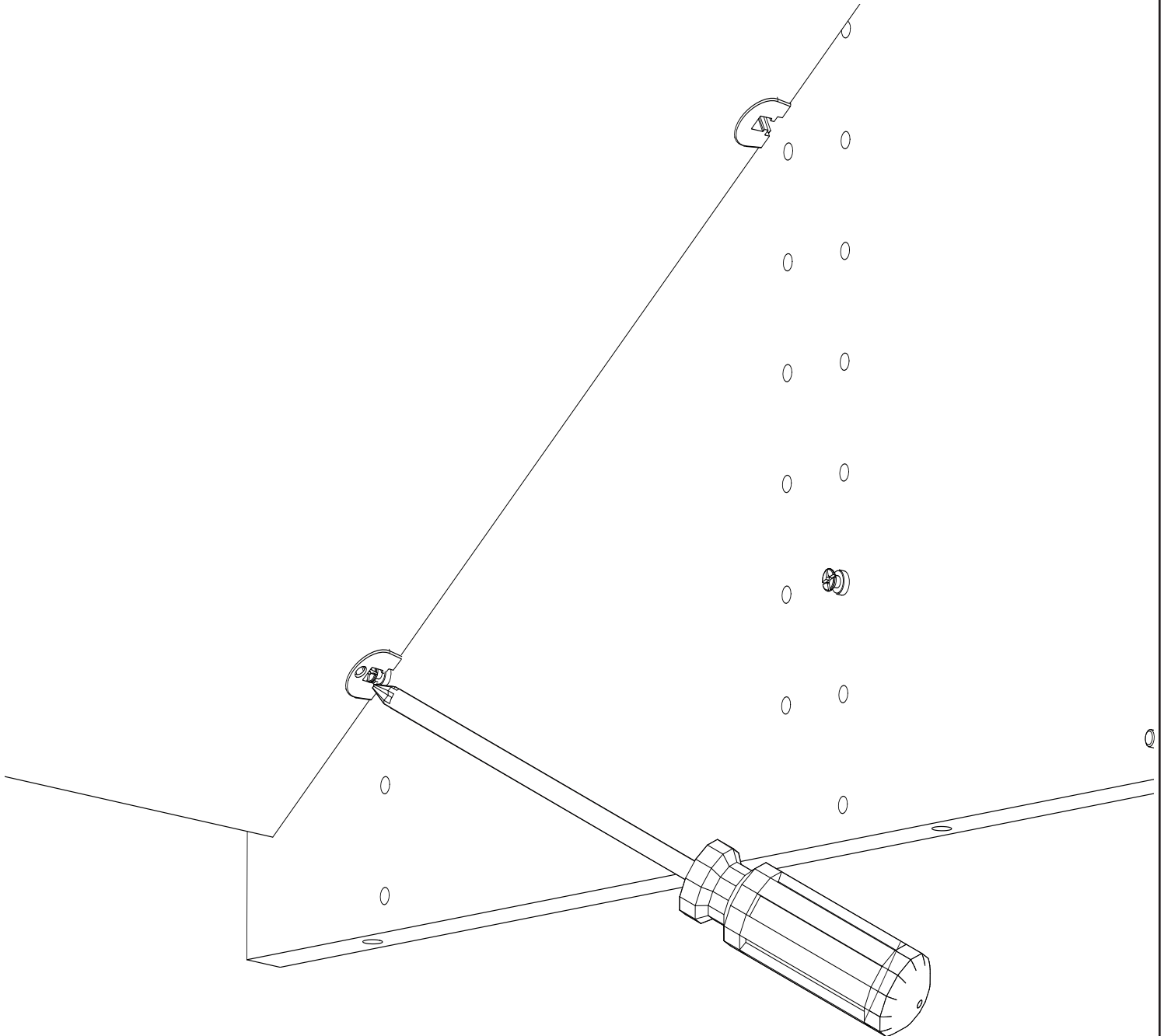

Step 13

Insert the toe kick by securing then tightening the rafixes.

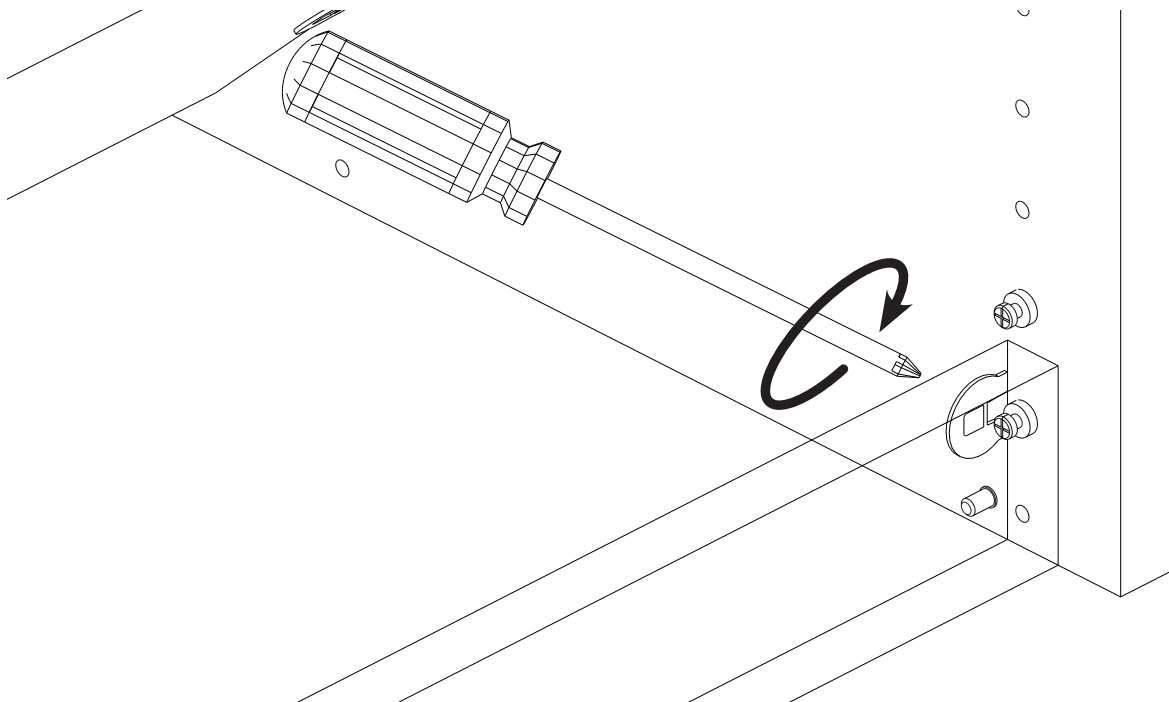
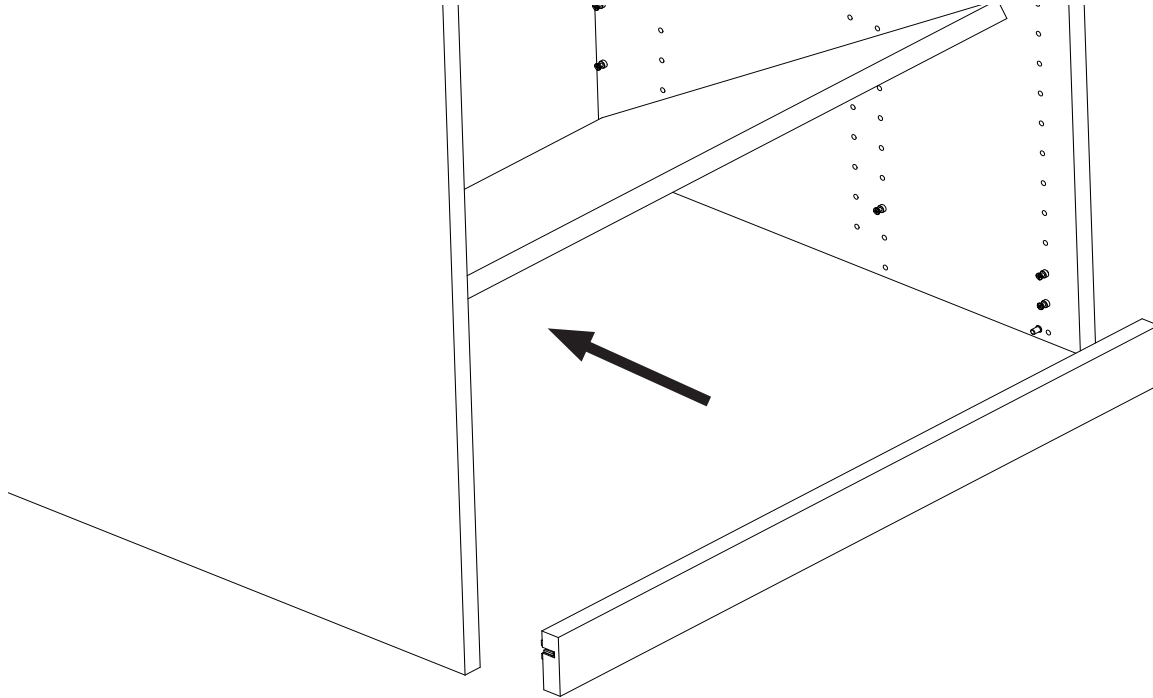



Step 14

Swing down the shelf to rest on the front 4 screw dowels.

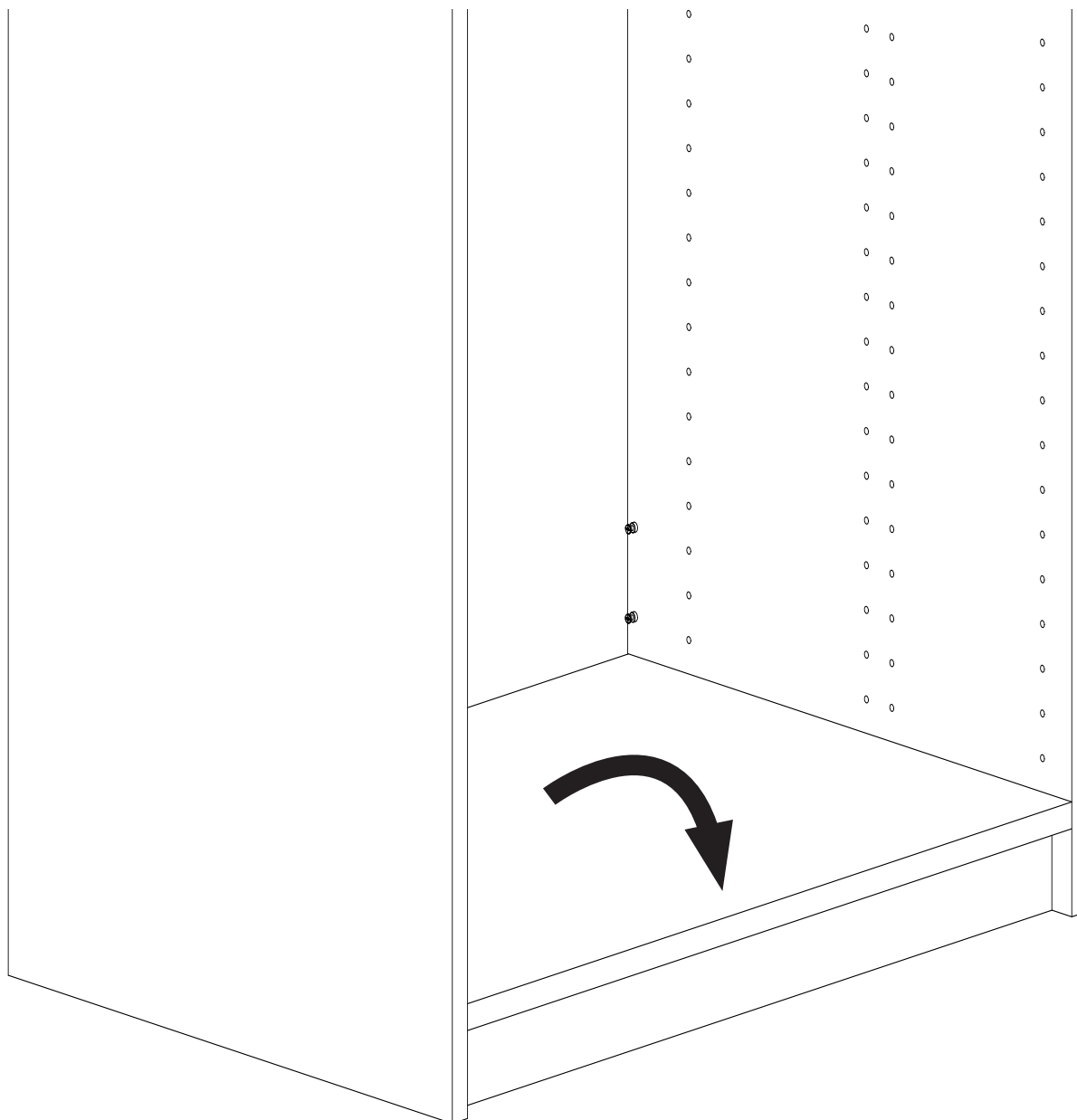

Step 15

Connect Bottom cleat by simply clicking the wedgfixes into the screw dowels on each side.

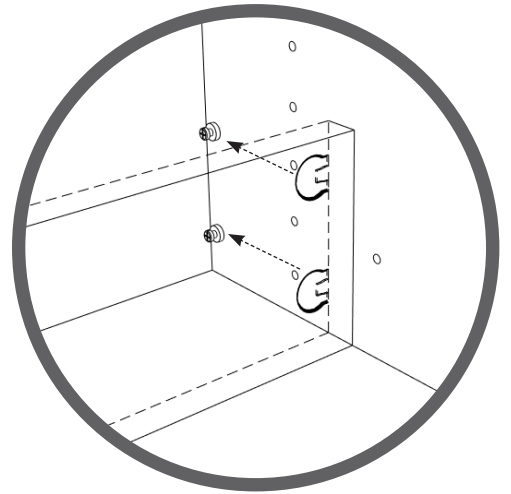
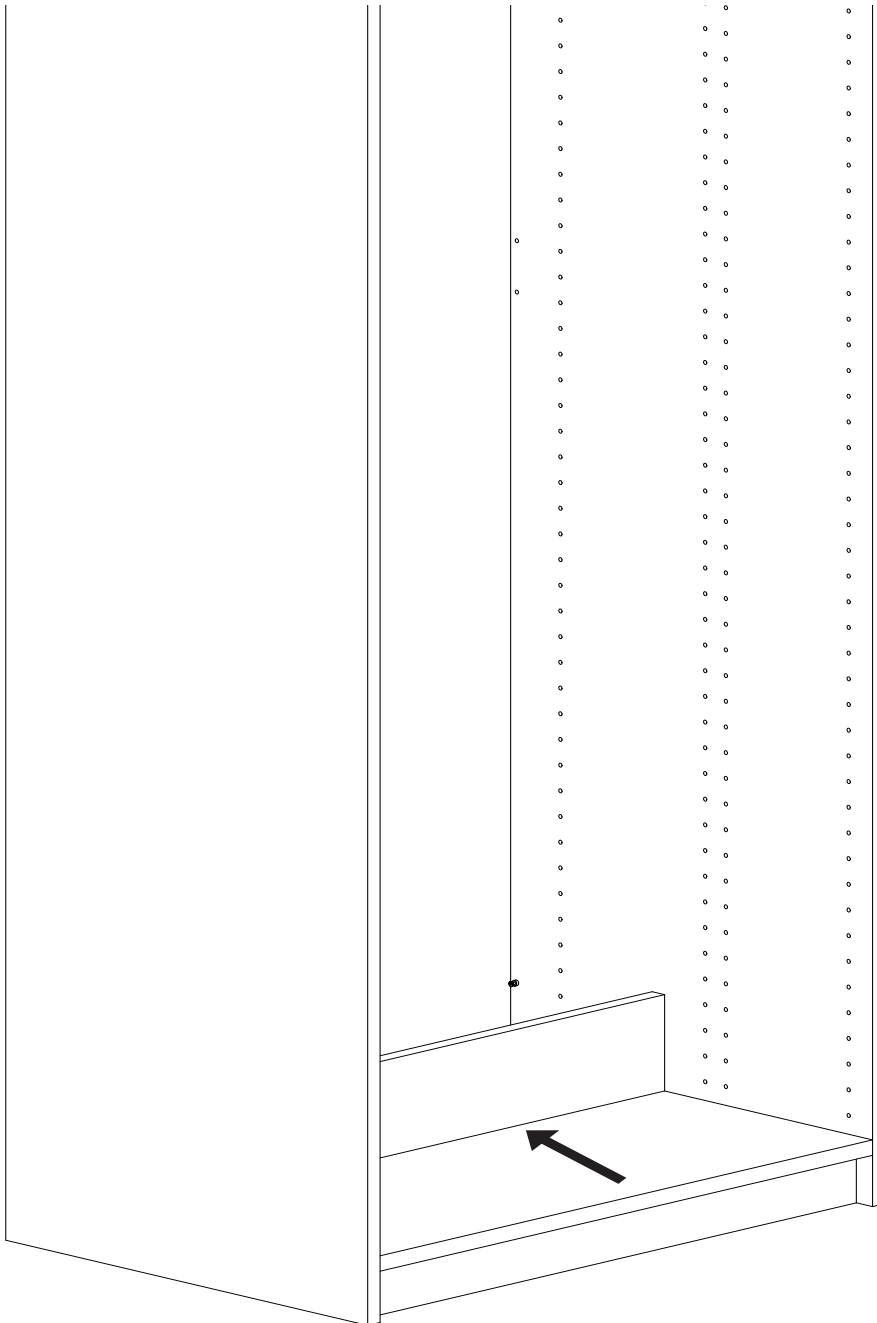



Step 16

You have now completed the first base unit! Simply repeat steps 8-15 for the remaining units.

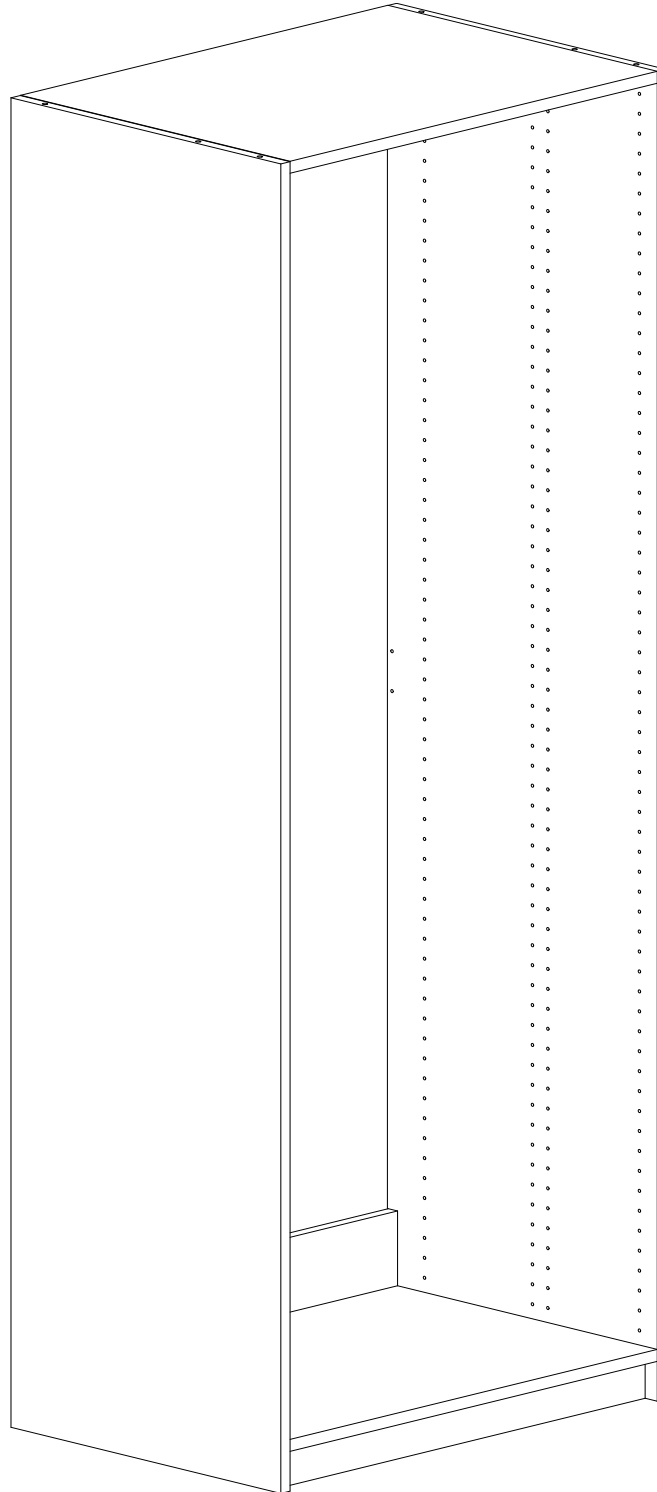

Step 17

Using a stud finder, search for the studs in the wall and drill the screws through the top and bottom cleats in each unit into the studs. If there is only one stud, drill two screws into each cleat, one on top of the other.

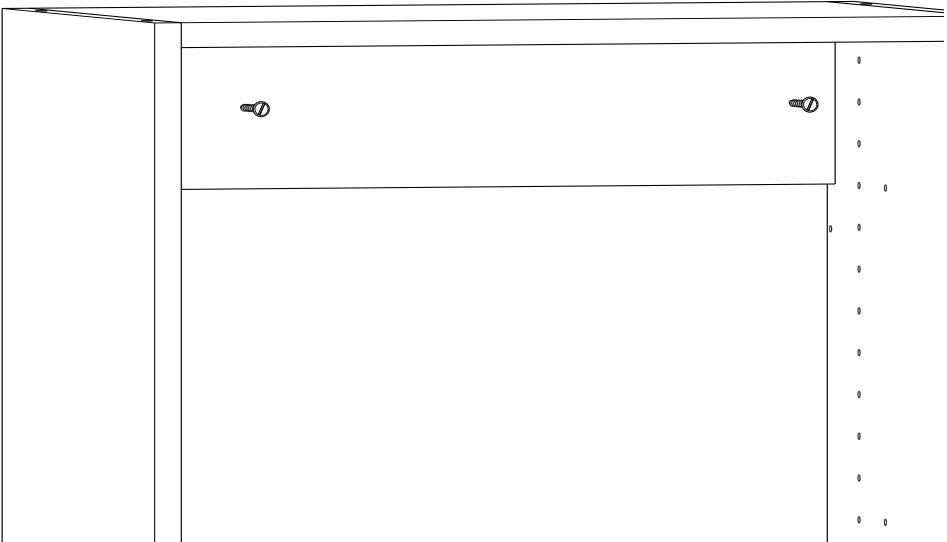

install screws
x4

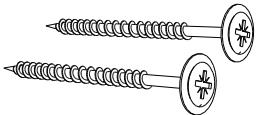



Door Assembly Parts Needed

Alto Door Pack
ALT-FDO

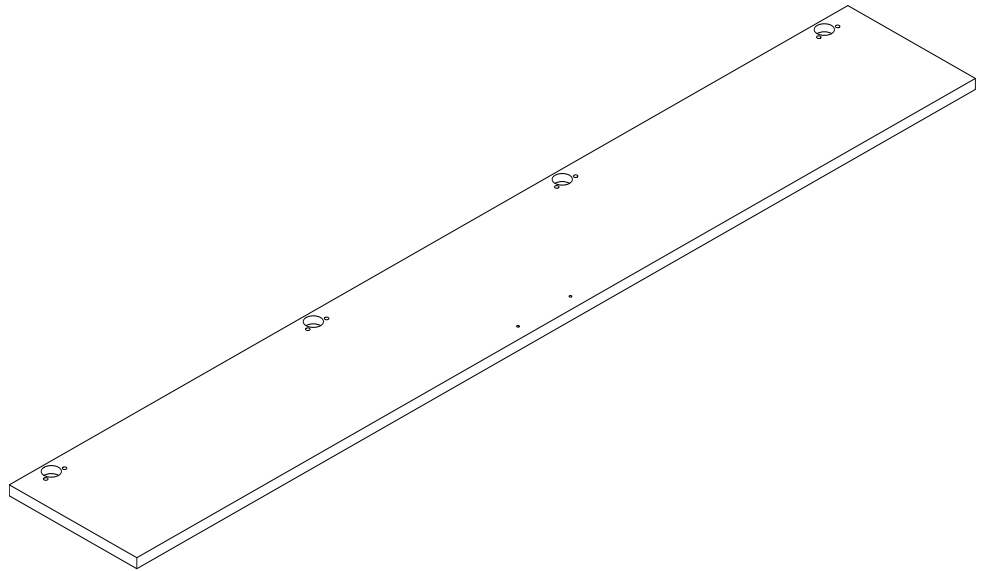

Hardware Packs Needed *ALT-HRDP- DO*

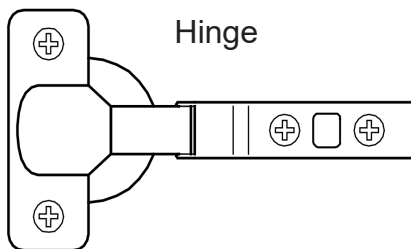

Hinge

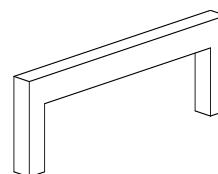

Pull

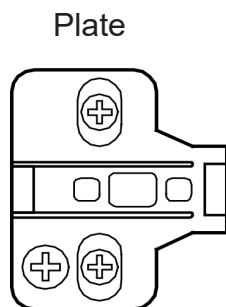

Plate

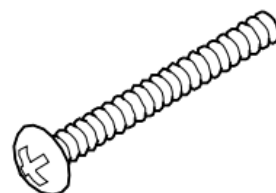

Pull Screw

Step 1

Take Alto-FDO and insert hinge hardware. Use screwdriver to tighten all captive screws into place.

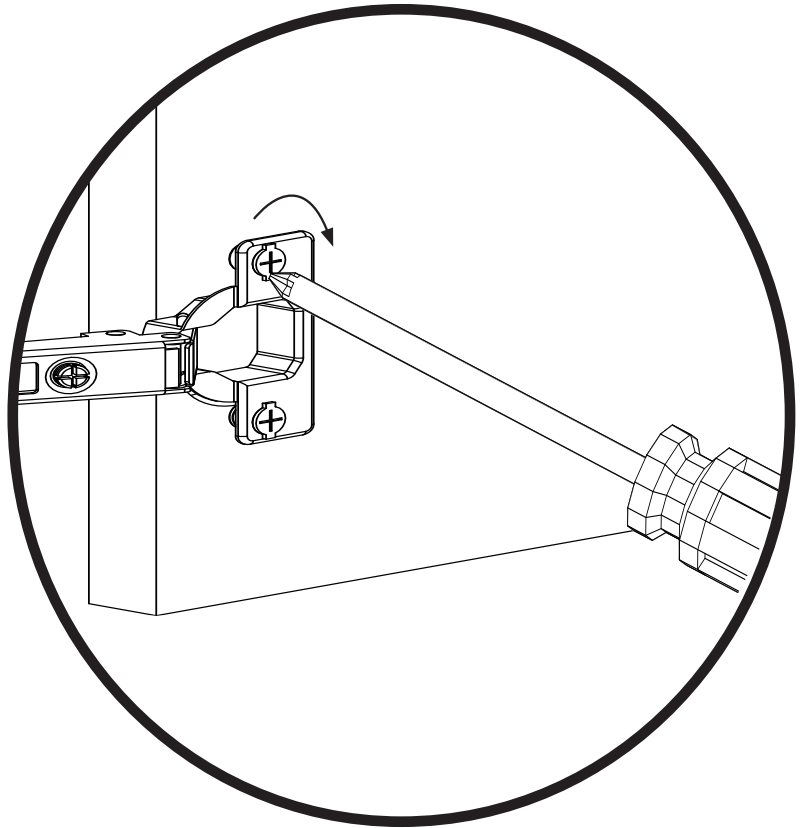
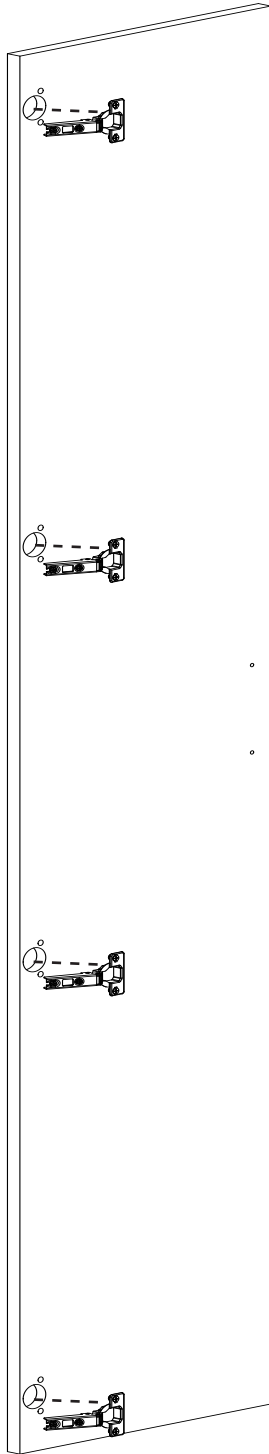



Step 2

Insert hinges into front drilling on built wardrobe side panels. Refer to image below for exact placings.

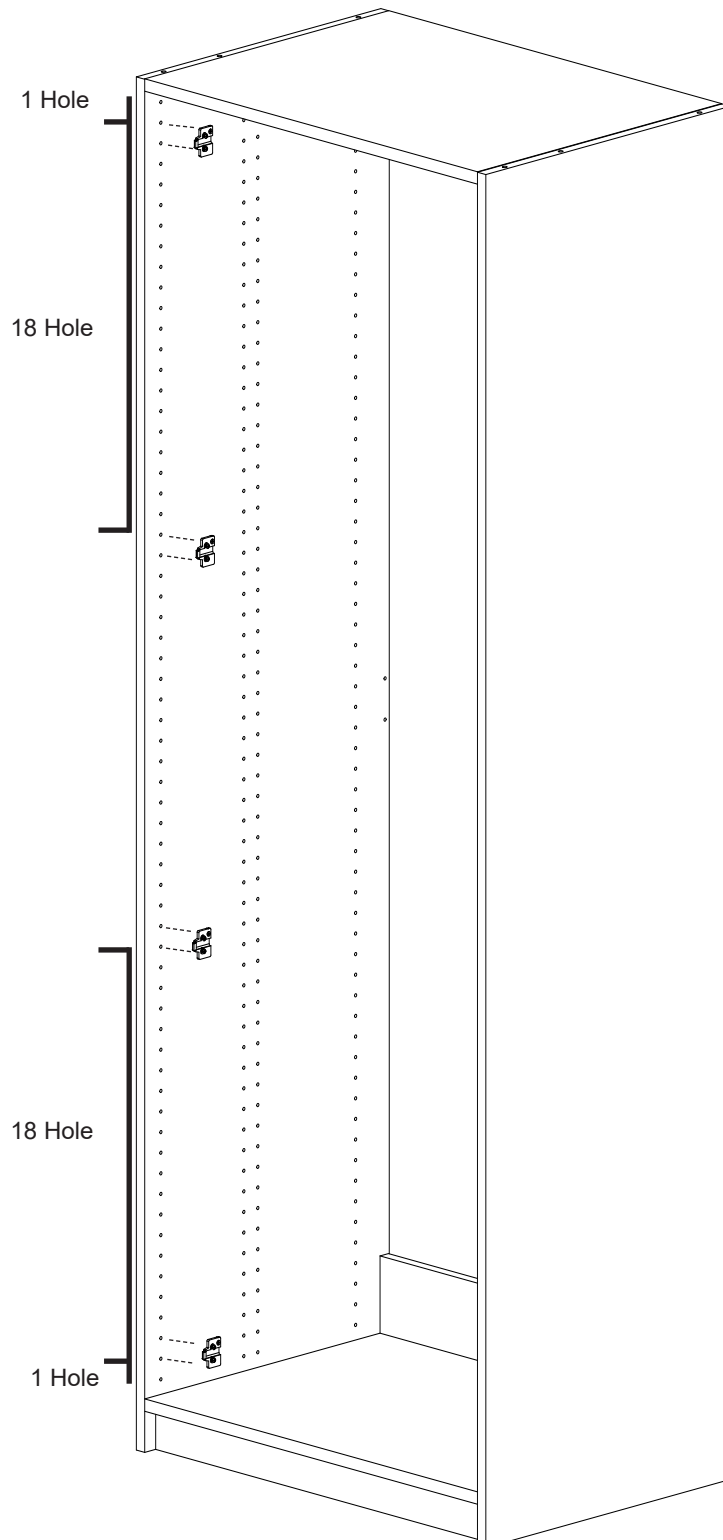

Step 3

After ensuring all plates are in the correct spots for door hinges to match, tighten all captive screws in plates.

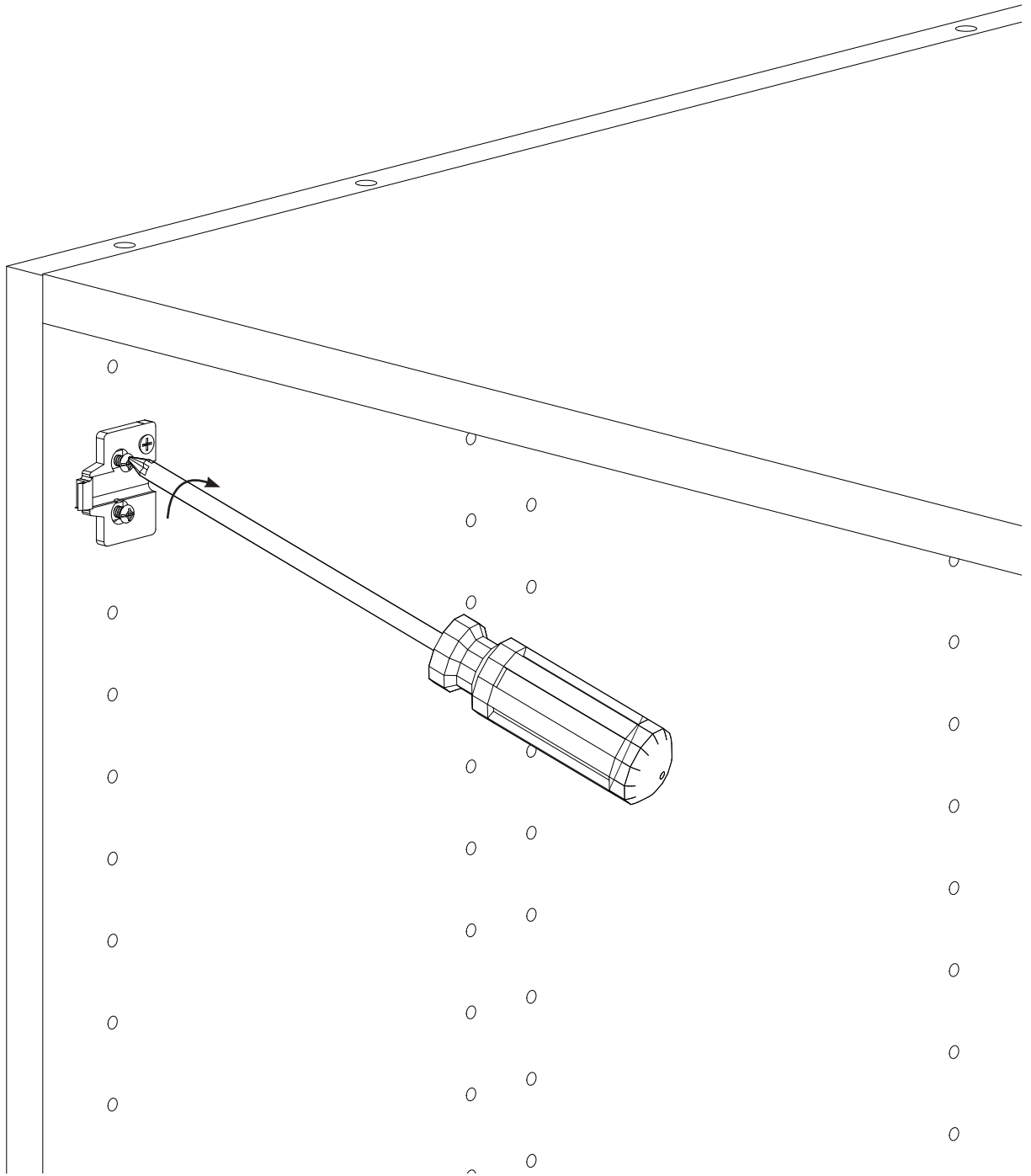



Step 4

Insert door hinges into plates. Make sure all 4 hinges click into each plate.

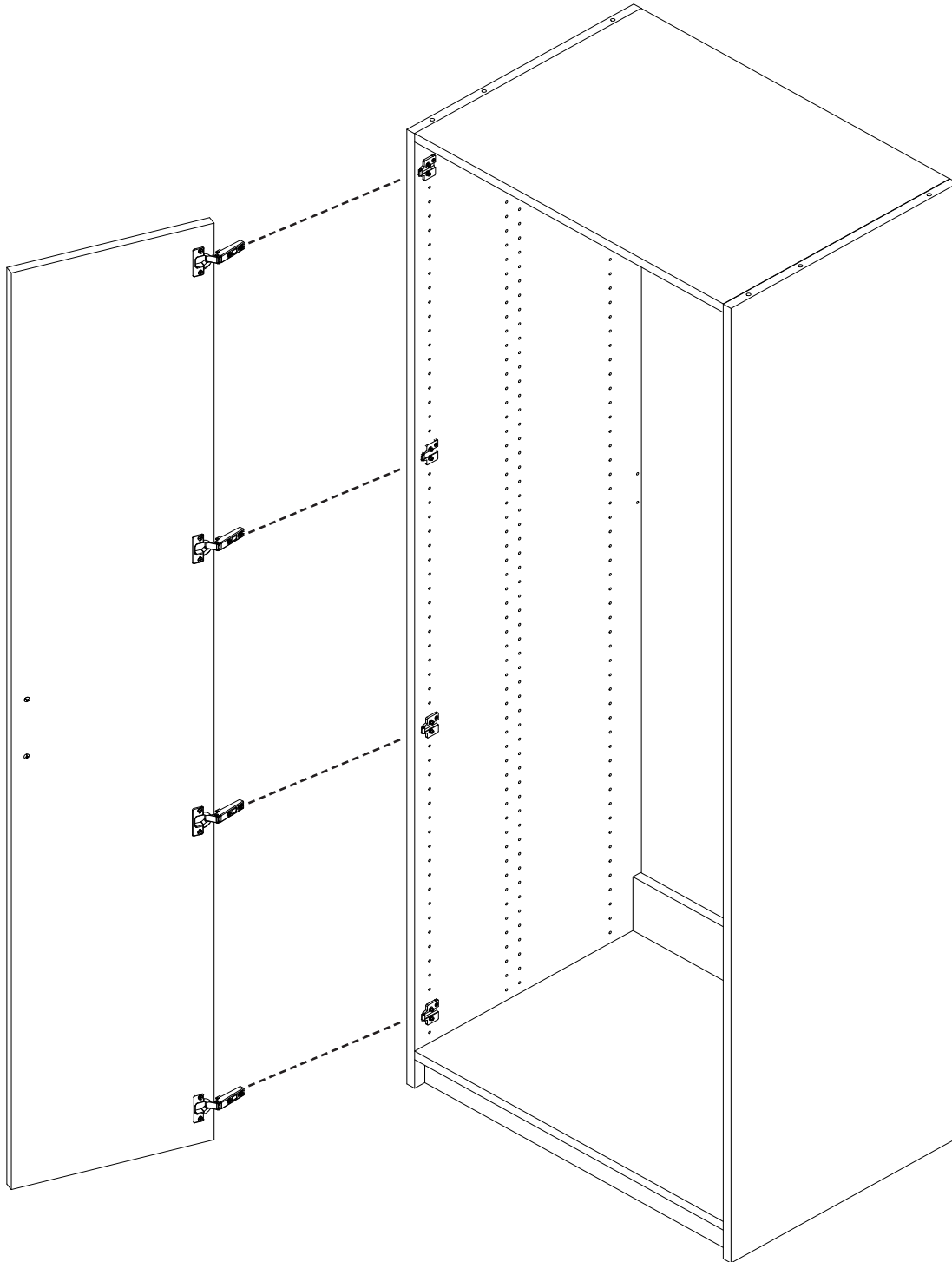



Interior component assembly

Refer to your closet plan for the interior components and follow the manual for assembly.

The default configurations shown here are just examples and may not always match your custom design.

Double Hang
Assembly

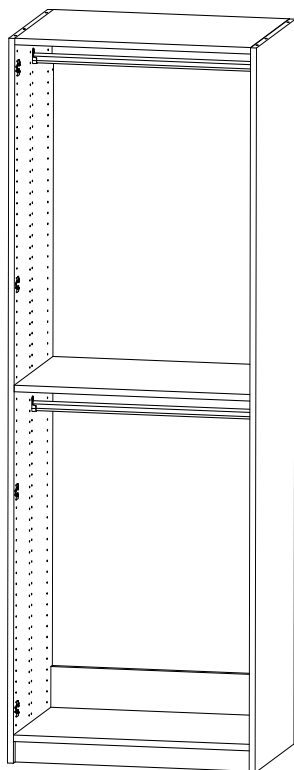

Page 30

Tall Hanging
Assembly

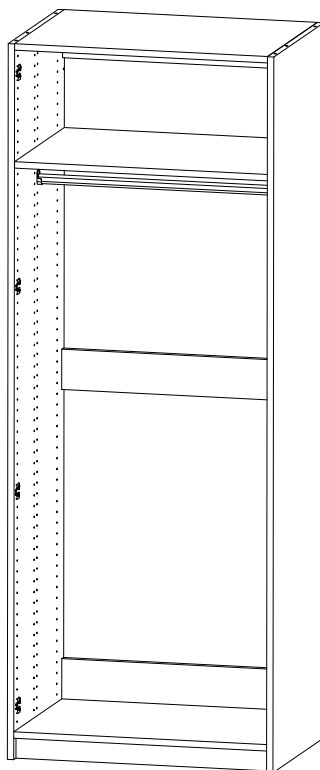

Page 34

Adjustable Shelf
Assembly

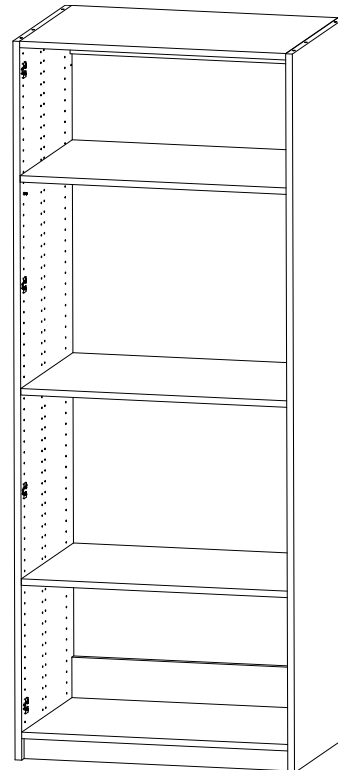

Page 38



Double Hang Assembly Parts Needed

Shelf Rod Pack

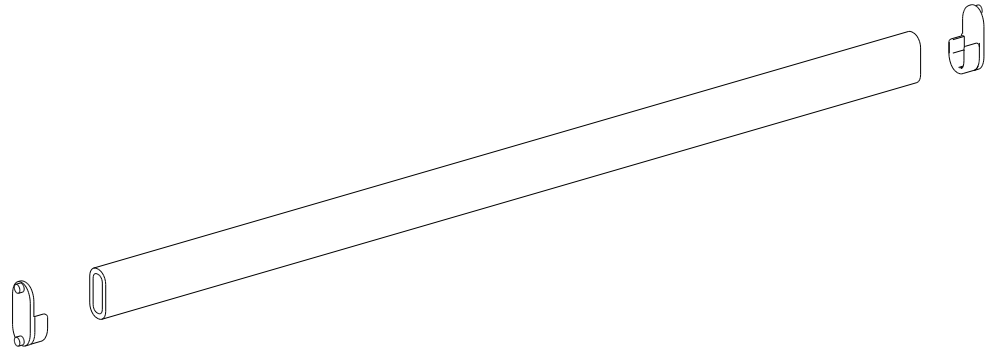

Middle Shelf
from
ALT-WRDB-FS
Alto Wardrobe Fixed Shelf Pack

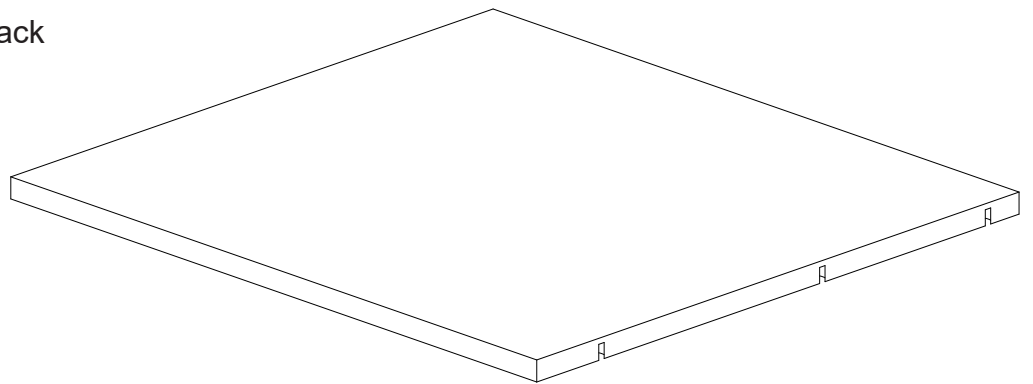



Step 1

Start by inserting the middle shelf by inserting screw dowels as shown and securing the shelf with the rafixes

Screw dowel

x4



Holes are on
same level
with top of
cleat holes

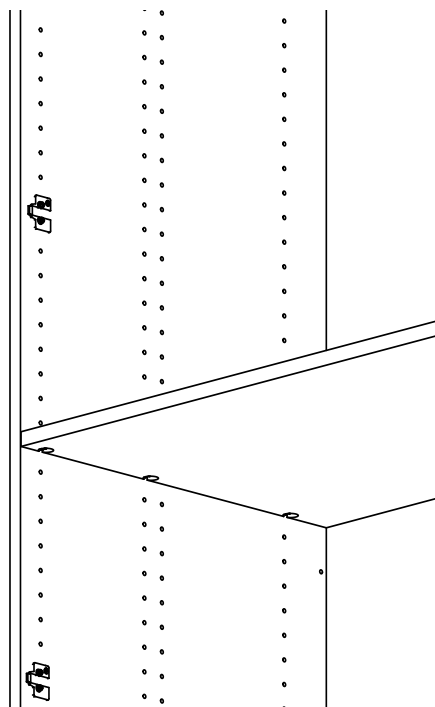
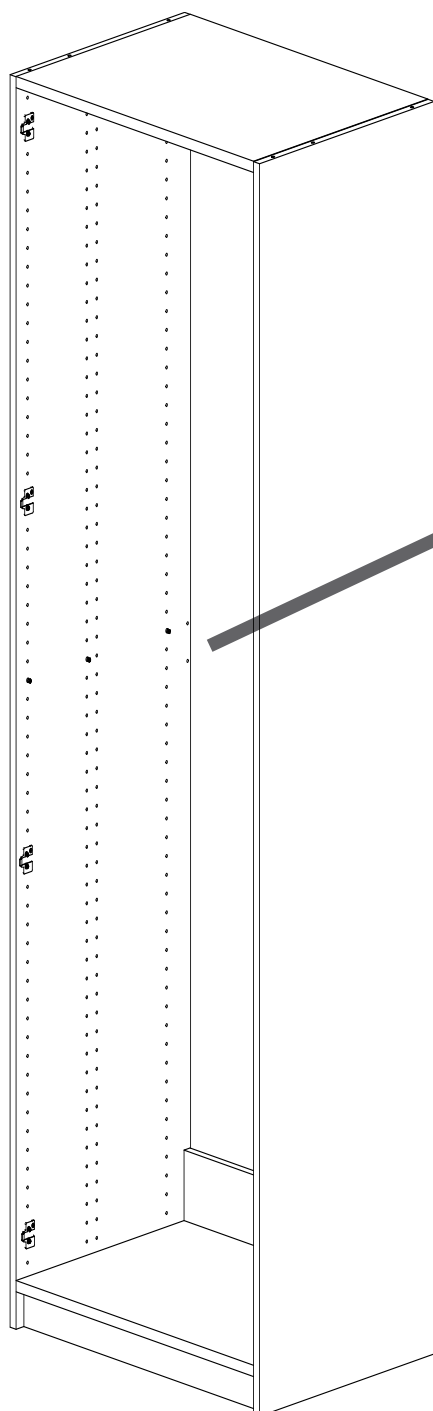



Step 2

Connect the rod flanges on either side and insert shelf rod under the top shelf

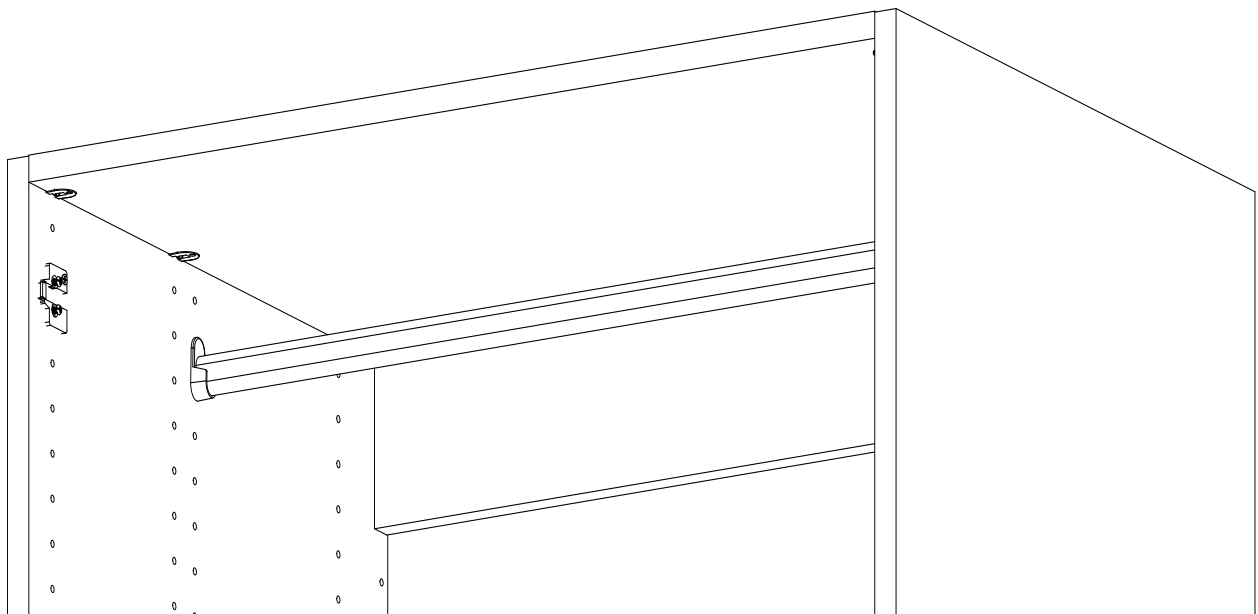
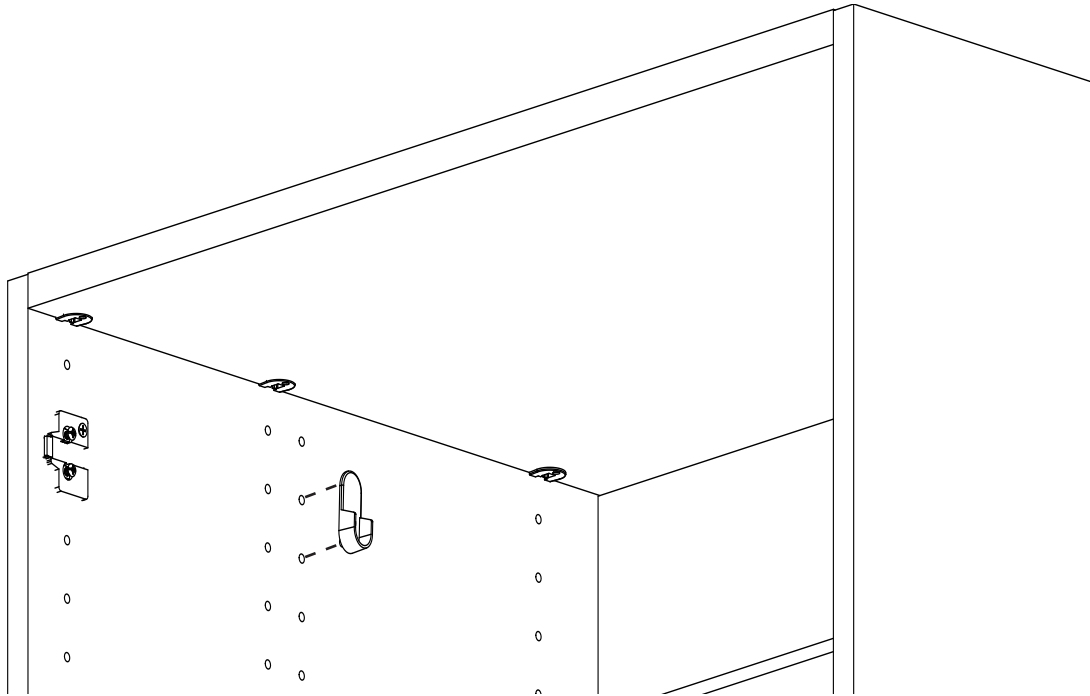

Step 3

Connect the rod flanges on either side and insert shelf rod under the middle placed shelf

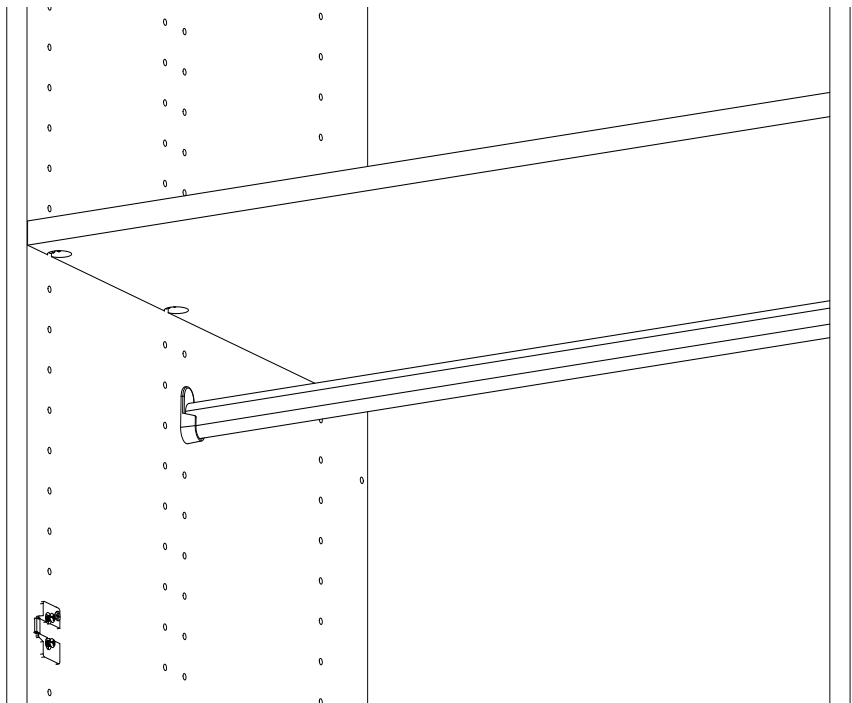
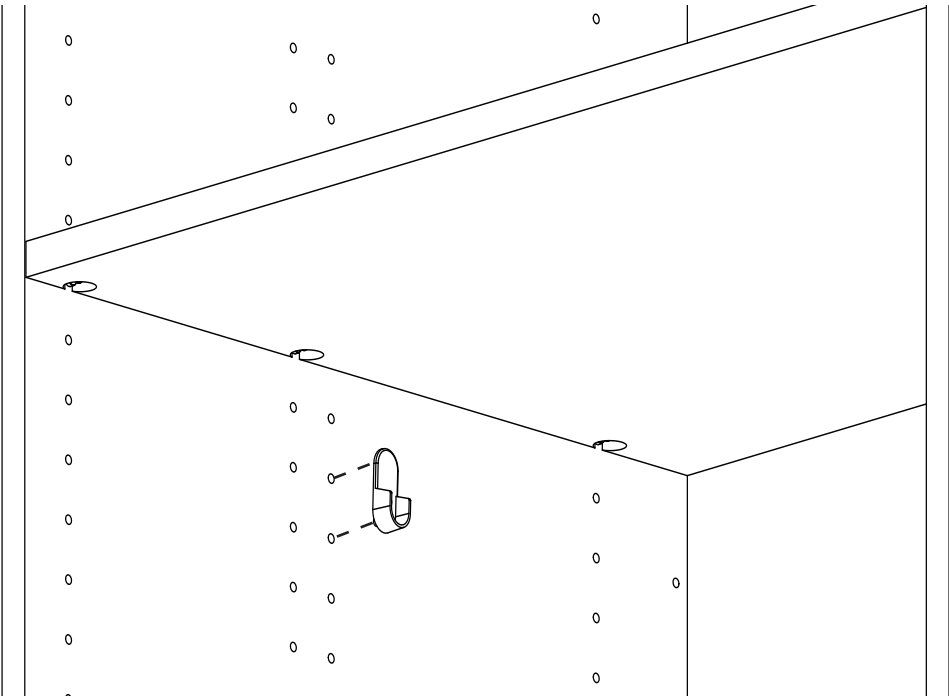



Tall Hang Assembly Parts Needed

Shelf Rod Pack

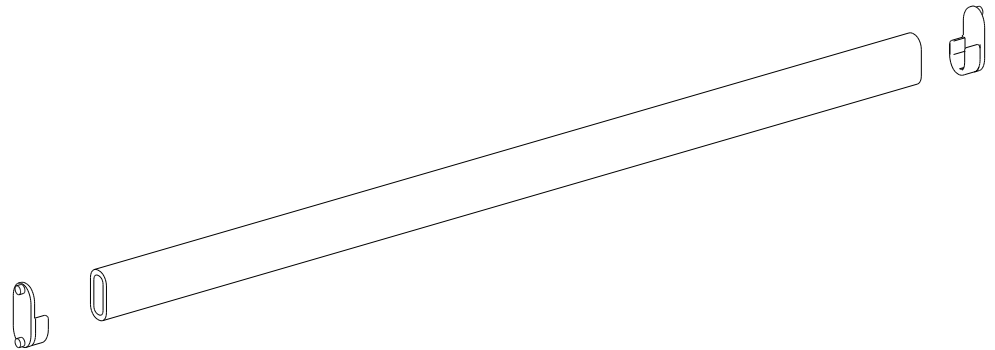

Third Cleat
&
Middle Shelf
from
ALT-WDR-FS
Alto Fixed Shelf Pack

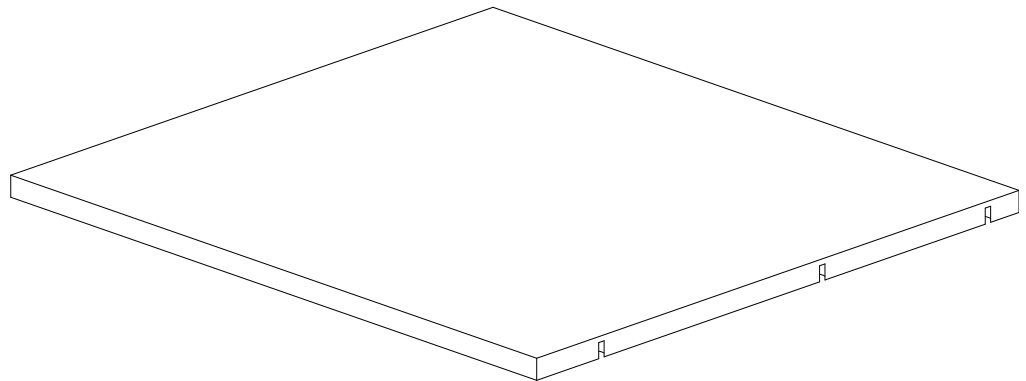
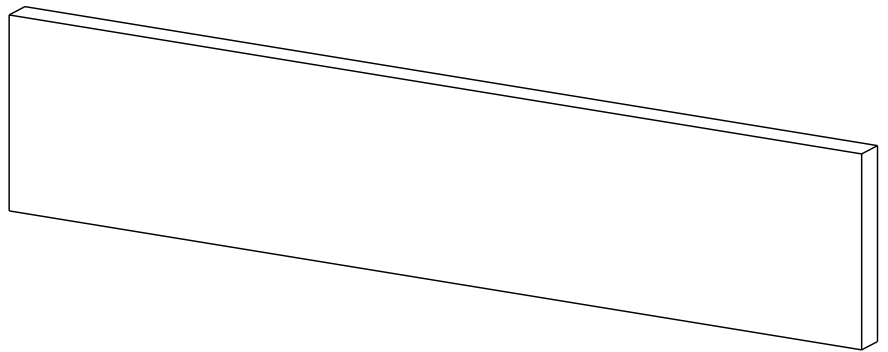

Step 1

Insert screws in the middle cleat holes on panels on both sides and simply click in the 3rd cleat

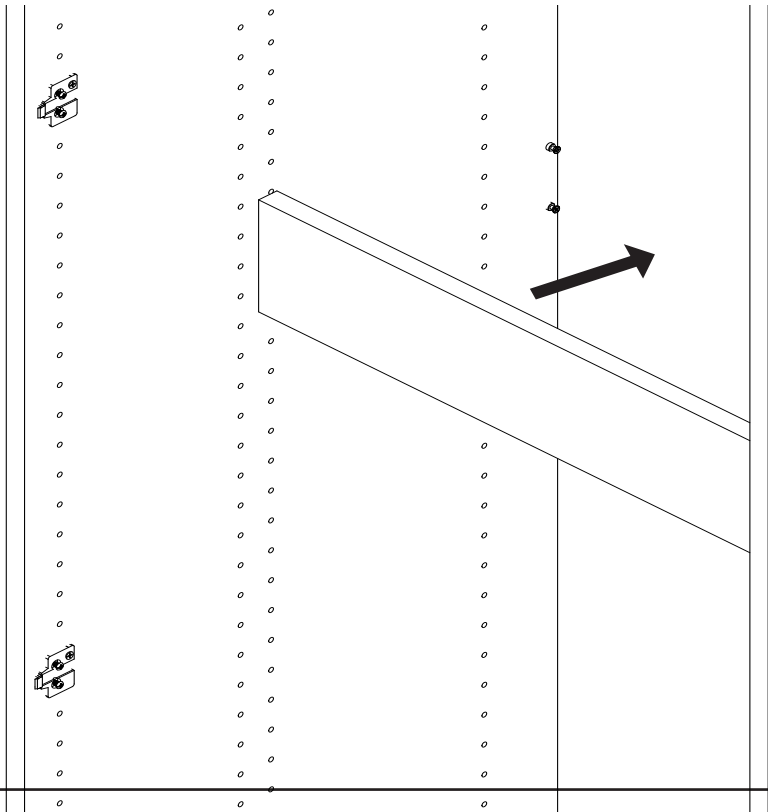
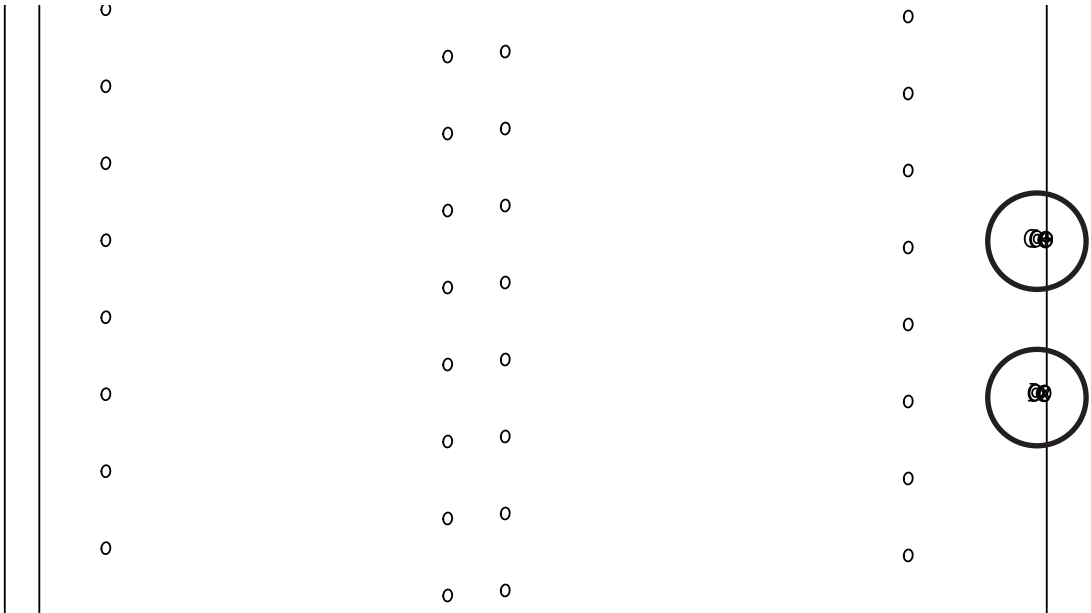



Step 2

Insert screw dowels in holes on panels on both sides and then connect and secure the middle shelf by turning the rafixes

Screw dowel

x4

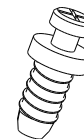

12th hole
including
the
top.

(Suggestion
only)

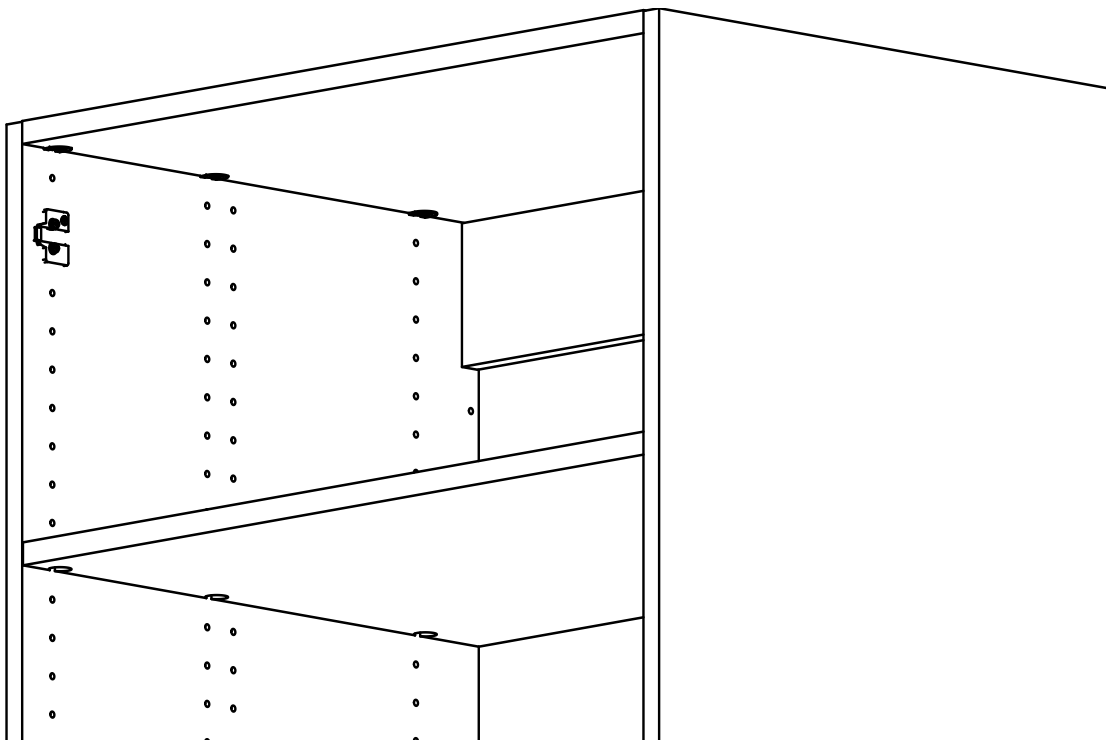
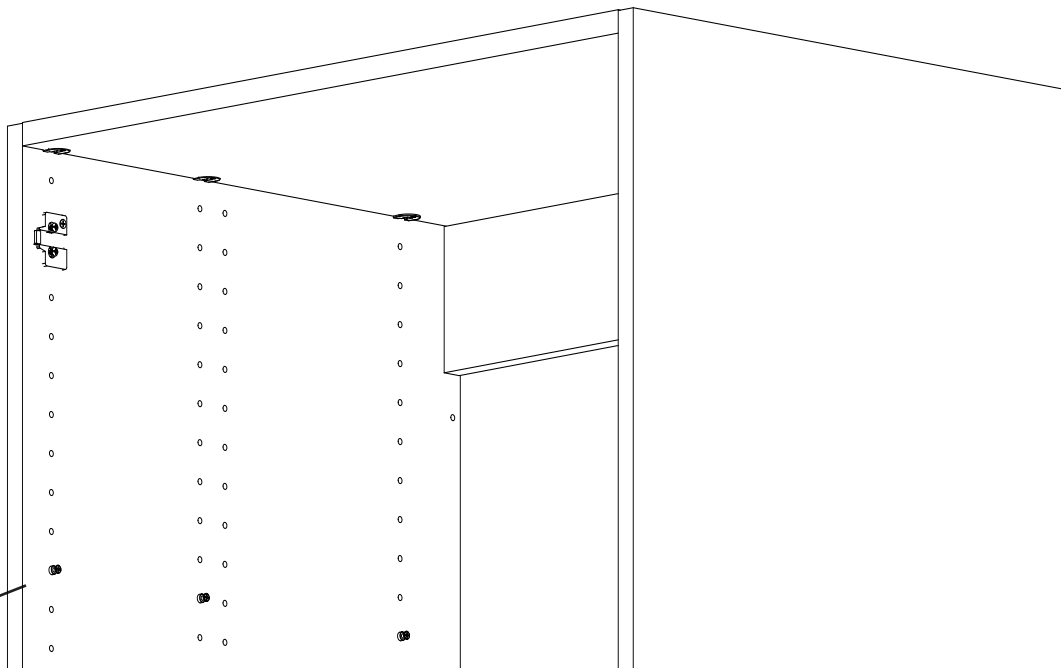

Step 3

Connect the rod flanges on either side and insert shelf rod

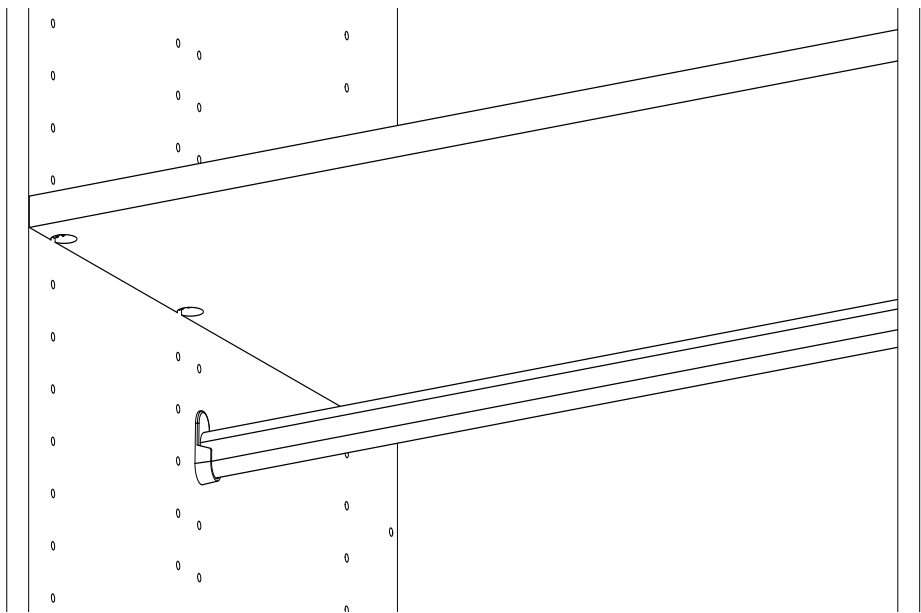
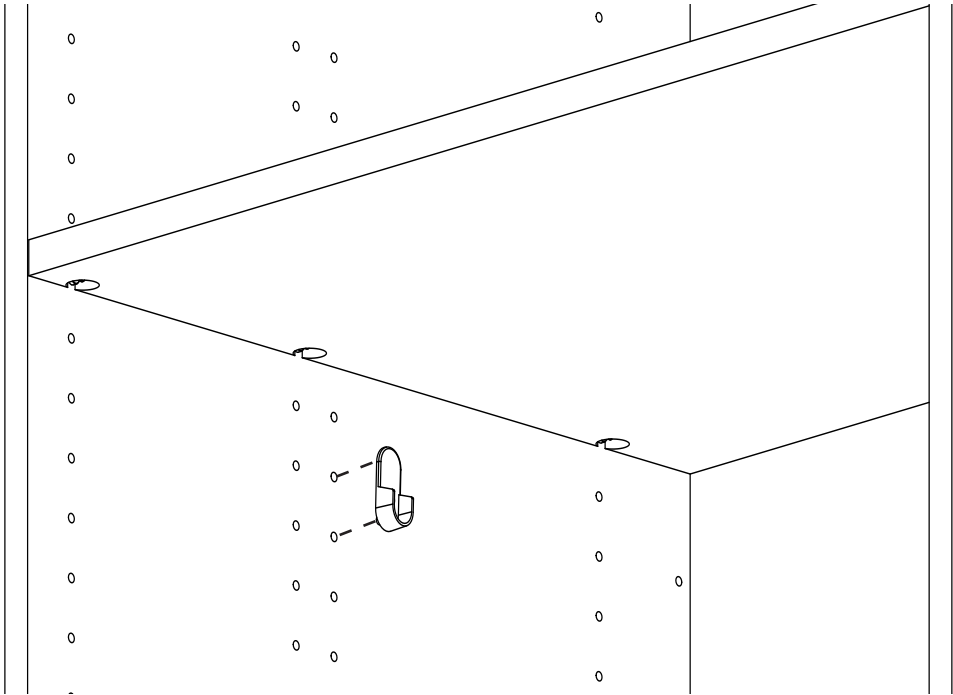



Adjustable Shelf Assembly Parts Needed

Adjustable Shelf
from
ALT--WRD-AS

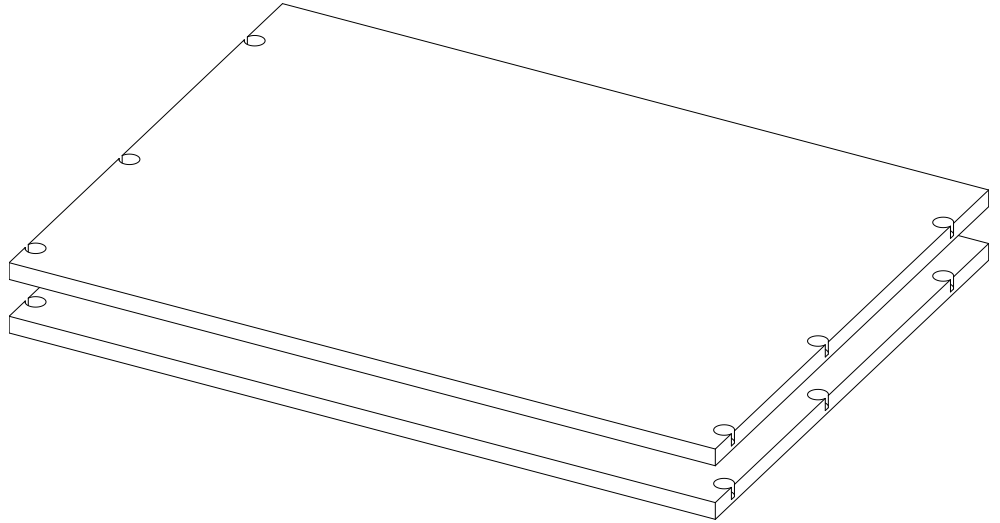

Hardware Packs Needed
ALT-HRDP-XXX

wedgefix
x12

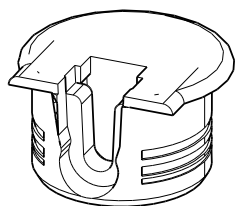

screw dowel
x12

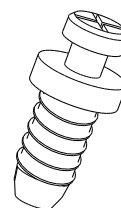



Step 1

Insert wedgefix hardware into any/all additional shelves being used.

Wedgefix
x6

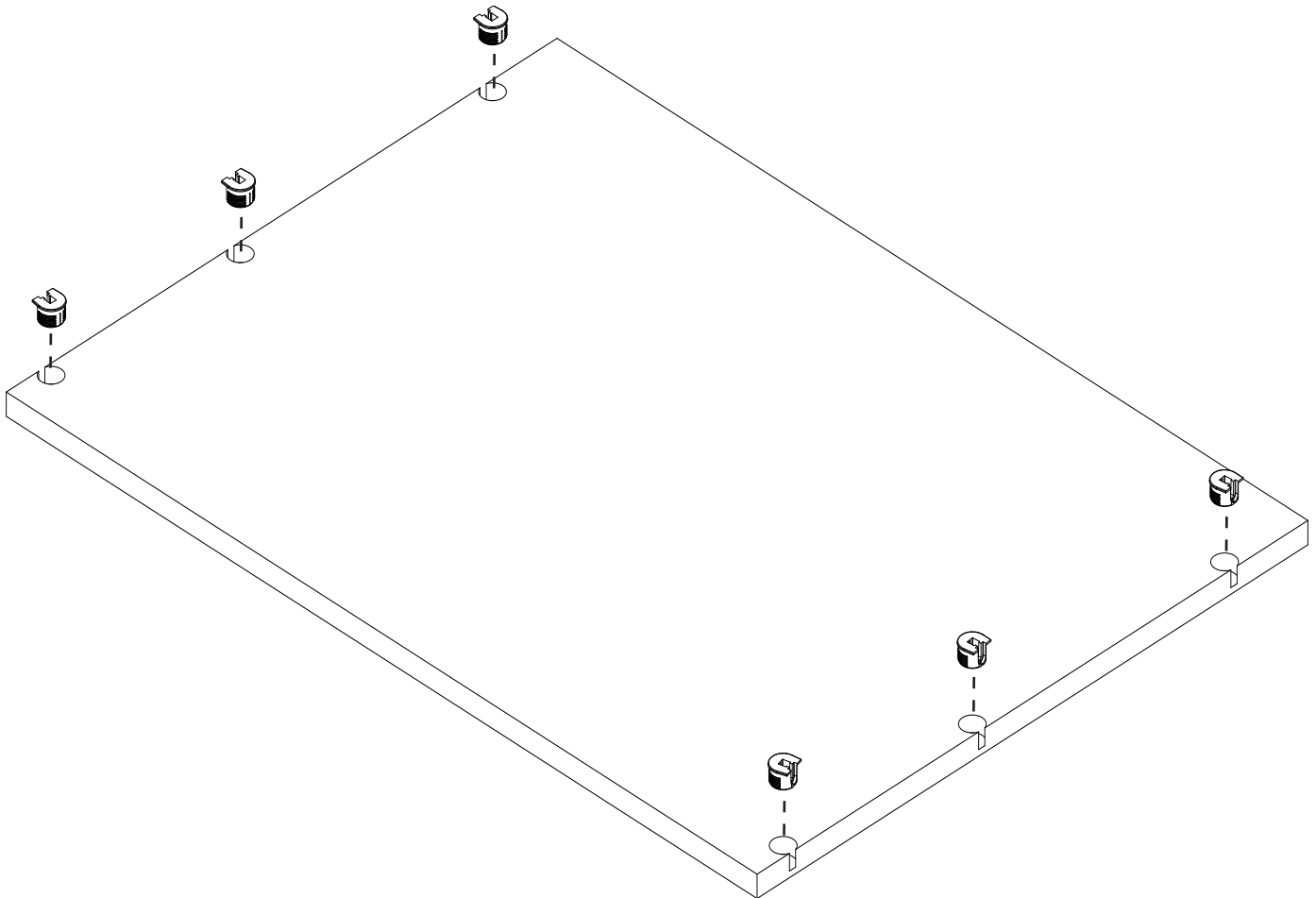



Step 2

Drill screws in panels where the adjustable shelf will be placed on both sides.
Press adjustable shelf into place.

Screw dowel

x6

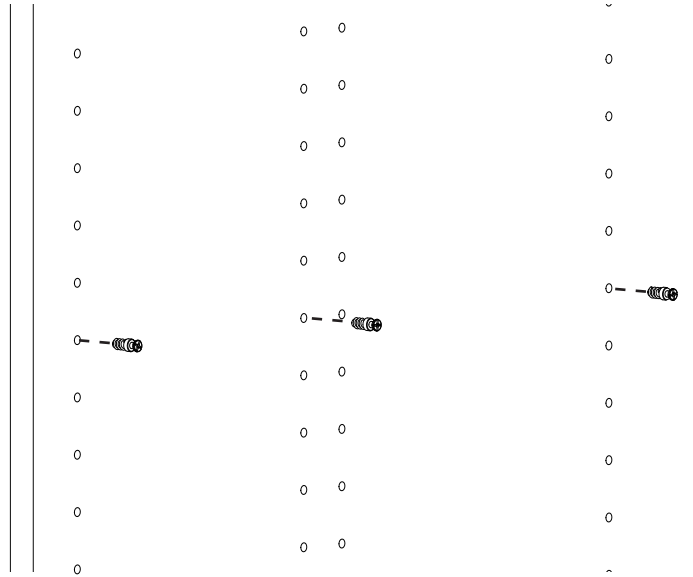
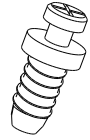

.....

